

WW25FG6B34BE

2.5 cu. ft. Smart Dial Front Load Washer
with Super Speed Wash and Steam

SAMSUNG



Available Color

White
WW25FG6B34BE

Features

- Super Speed Wash
- AI Smart Dial
- Wi-Fi Connectivity¹
- 2.5 cu. ft. Capacity
- Steam
- Drum Clean+
- Vibration Reduction Technology+
- Swirl Drum Interior
- Closet-Depth Fit²
- Flexible Installation
- ENERGY STAR® Most Efficient
- AI Energy Mode
- Digital Inverter Motor
- 1400 RPM Maximum Spin Speed
- Internal Water Heater
- 24 Total Washing Cycles
- 14 Options

Convenience

- Child Lock
- Dispenser Trays: Main Wash, Softener, Bleach

Ratings



ENERGY STAR® Most Efficient
CEE Tier 3
IMEF = 2.25
IWF = 3.7
90 kWh/yr

Electrical Requirements

120 V / 60 Hz
15 Amps

Specifications

24 Total Washing Cycles:
Eco Cold, Normal, Heavy Duty, Perm Press, Towels, Self Clean+, Activewear, Delicates, Wool, Rinse+Spin, Bedding, Small Load, Colors, Spin Only, Outdoor, Denim, Super Speed, Steam Sanitize, Steam Allergen, Steam Normal, Power Steam, Steam Whites, Steam Bedding, Power Rinse

14 Additional Washing Options:
Super Speed, Delay End, My Cycles, Pre Soak, Extra Rinse, Smart Control, AI Pattern, Volume, Calibration, Wi-Fi, Language, Child Lock, Factory Reset, Self Diagnosis

5 Temperature Settings:
Extra Hot, Hot, Warm, Cold, Tap Cold

6 Spin Settings:
Extra High, High, Medium, Low, Extra Low, No Spin

5 Soil Settings:
Extra Heavy, Heavy, Normal, Light, Extra Light

Warranty
One (1) Year Parts and Labor
Three (3) Years Stainless Steel Tub (Part Only)
Twenty (20) Years Washing DIT (Digital Inverter Motor) Motor Part (Part Only)

Product Dimensions & Weight (WxHxD)
Dimensions: 23⁵/₈" x 33¹/₂" x 25⁷/₁₆"
Weight: 158.7 lbs

Shipping Dimensions & Weight (WxHxD)
Dimensions: 26³/₈" x 34⁵/₈" x 27¹/₁₆"
Weight: 163.1 lbs

Washer	Model #	UPC Code	Optional Accessory	Model #	UPC Code
White	WW25FG6B34BEA2	198957226892	Stacking Kit	SKK-DF	198957238253
Matching Electric Dryer					
White	DV25FG60BVBEA2	198957233555			
Matching Heat Pump Dryer					
White	DV25FG62B0BEA2	198957233562			

¹ Requires wireless network, Samsung account and Samsung SmartThings App. The Samsung SmartThings App supports Android OS 4.0 (ICS) or later, which is optimized for Samsung smartphones (Galaxy S and Galaxy Note series). This app also supports iOS 7 or later for iPhone models. Samsung SmartThings App available in App Store and Play Store.

² Designed to fit a 30" installation depth.

WW25FG6B34BE

2.5 cu. ft. Smart Dial Front Load Washer
with Super Speed Wash and Steam

SAMSUNG

Dimensions

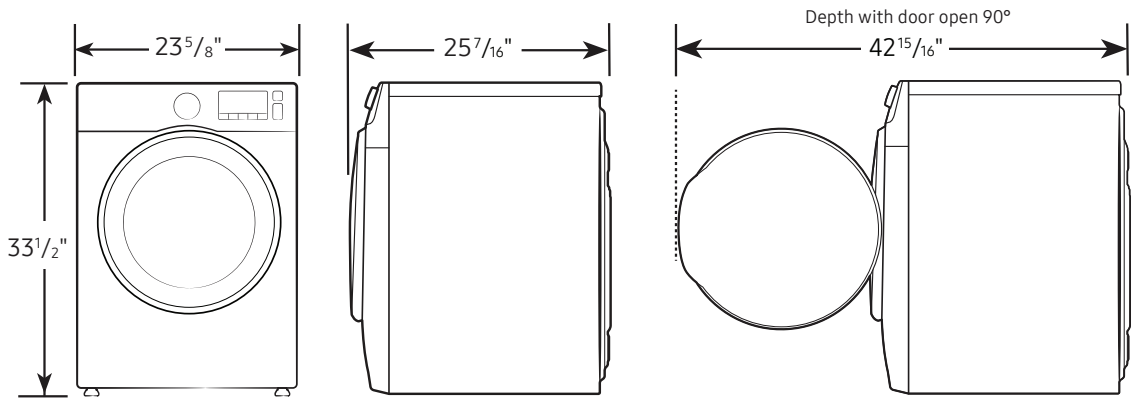

Installation Specifications – Side-by-Side or Stand-Alone

If the washer and dryer are installed together or the dryer alone, the closet front must have two unobstructed air openings for a combined minimum total area of 72-inch². Your washer alone does not require a specific air opening.

Alcove or closet installation
Minimum clearances for
closet and alcove installations:

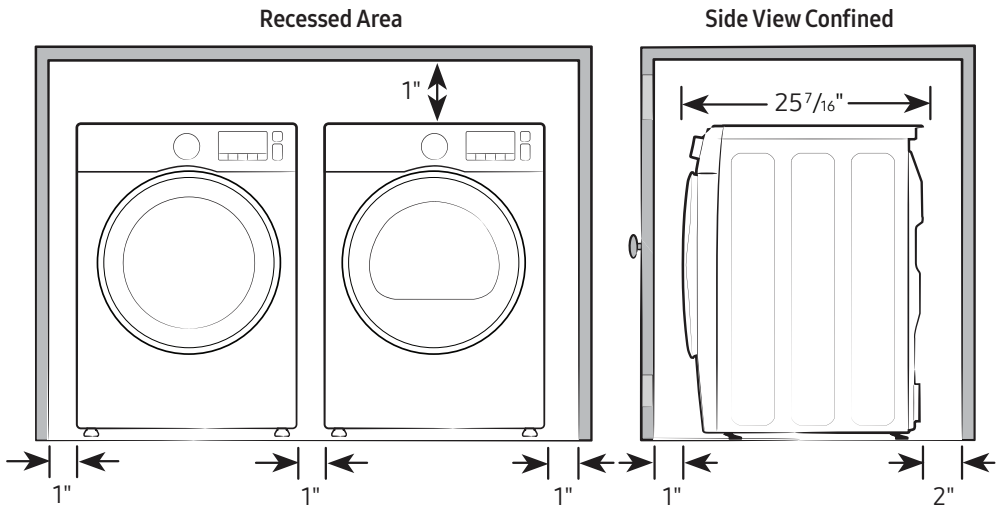

Connection Dimensions

Back view of washer

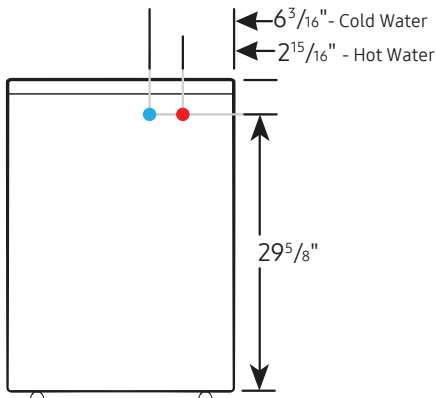

- LEGEND:
- Cold Water Connection
 - Hot Water Connection

Actual color may vary. Design, specifications, and color availability are subject to change without notice. Non-metric weights and measurements are approximate.

©2025 Samsung Electronics America, Inc., 700 Sylvan Avenue, Englewood Cliffs, NJ 07632. Tel: 800-SAMSUNG. samsung.com. Samsung is a registered trademark of Samsung Electronics Co., Ltd.

WW25FG6B34BE

SAMSUNG

2.5 cu. ft. Smart Dial Front Load Washer
with Super Speed Wash and Steam

Installation Specifications – Stacked Pair

Clearances indicated are for stacked pairs. The closet front must have two unobstructed air openings for a combined minimum total area of 72-inch².

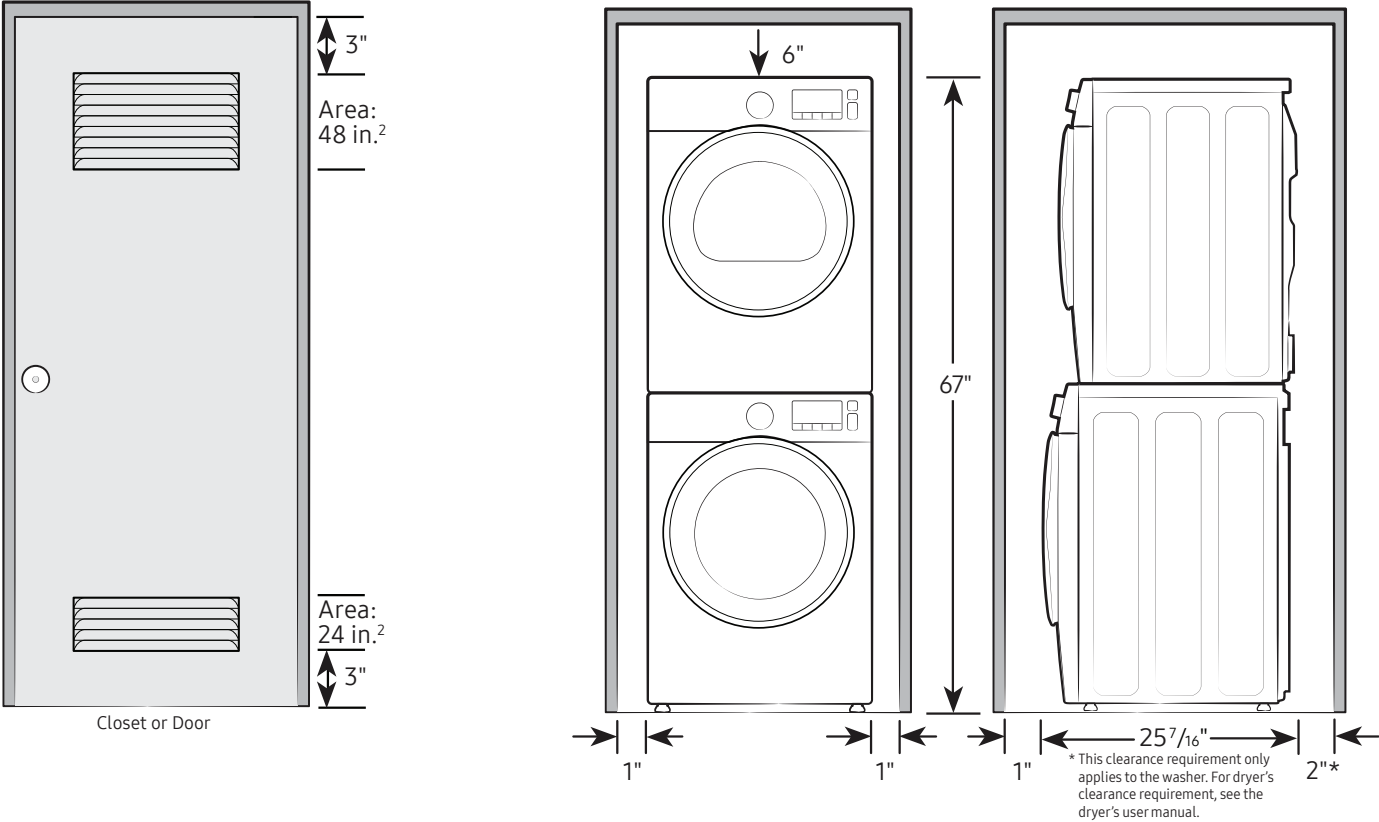

Connection Dimensions

Back and side views of stacked pair

- LEGEND:
- Cold Water Connection
 - Hot Water Connection

Actual color may vary. Design, specifications, and color availability are subject to change without notice. Non-metric weights and measurements are approximate.

©2025 Samsung Electronics America, Inc., 700 Sylvan Avenue, Englewood Cliffs, NJ 07632. Tel: 800-SAMSUNG. samsung.com. Samsung is a registered trademark of Samsung Electronics Co., Ltd.

