



webOS Hub

INSTRUCTION MANUAL



Manufactured under license from Dolby Laboratories. Dolby, Dolby Audio, and the double-D symbol are trademarks of Dolby Laboratories Licensing Corporation.



The Adopted Trademarks HDMI, HDMI High-Definition Multimedia Interface, and the HDMI Logo are trademarks or registered trademarks of HDMI Licensing Administrator, Inc. in the United States and other countries.



ENERGY STAR® Qualification.

Enabling certain features and functionality in this product (e.g. Picture Mode, Volume) may increase its energy consumption, possibly beyond the limits required for ENERGY STAR® qualification.

This product has earned the ENERGY STAR® qualification meeting US Federal Energy Efficiency guidelines as established by the Department of Energy and Environmental Protection Agency. The ENERGY STAR® program exists to provide energy saving guidelines and help promote energy efficient products and practices.

Power Saving Mode is the mode in which the product qualifies for ENERGY STAR®.

IMPORTANT

Please read this manual carefully before installing and operating the TV

Keep this manual handy for further reference

GQTVOMVW01

Content

Safety Information	1
Important Safety Precautions	2
TV Buttons And Connections	3
External Device Connection Diagram	3
TV Install And Connect.	4
TV Stand Installation Instructions	4
OSD	5
1、 First Time Installation	5
2、 Home page.....	6
3、 TV Setting.....	7
4、 Media	9
Help.	11
Specifications	12
Remote Controller.	13
Warranty	14

Safety Information

	CAUTION / ATTENTION RISK OF ELECTRIC SHOCK. DO NOT OPEN RISQUE D'ELECTROCUTION. NE PAS OUVRIR.	
CAUTION: TO REDUCE THE RISK OF ELECTRIC SHOCK, DO NOT REMOVE COVER (OR BACK). NO USER-SERVICEABLE PARTS INSIDE. REFER SERVICING TO QUALIFIED SERVICE PERSONNEL.		



The lightning flash with arrowhead symbol, within an equilateral triangle is intended to alert the user to the presence of uninsulated dangerous voltage within the product's enclosure that may be of sufficient magnitude to constitute a risk of electric shock.



The exclamation point within an equilateral triangle is intended to alert the user to the presence of important operating and maintenance (servicing) instructions in the literature accompanying the appliance.

WARNING: TO PREVENT FIRE OR SHOCK HAZARD, DO NOT EXPOSE THIS APPLIANCE TO RAIN OR MOISTURE. TO PREVENT THE SPREAD OF FIRE, KEEP CANDLES OR OPEN FLAMES AWAY FROM THIS PRODUCT AT ALL TIMES.
CAUTION: TO PREVENT ELECTRIC SHOCK. DO NOT USE THIS POLARIZED PLUG WITH AN EXTENSION CORD, RECEPTACLE OR OTHER OUTLET UNLESS THE BLADES CAN BE FULLY INSERTED TO PREVENT BLADE EXPOSURE.

WARNING: This equipment has been tested and found to comply with the limits for a Class B digital device, pursuant to Part 15 of the FCC Rules. These limits are designed to provide reasonable protection against harmful interference in a residential installation. This equipment generates, uses and can radiate radio frequency energy and, if not installed and used in accordance with the instructions, may cause harmful interference to radio communications. However, there is no guarantee that interference will not occur in a particular installation. If this equipment does cause harmful interference to radio or television reception, which can be determined by turning the equipment off and on, the user is encouraged to try to correct the interference by one or more of the following measures:

- Reorient or relocate the receiving antenna.
- Increase the separation between the equipment and receiver.
- Connect the equipment into an outlet on a circuit different from that to which the receiver is connected.
- Consult the dealer or an experienced radio/TV technician for help.



CAUTION: Changes or modifications not expressly approved by the party responsible for compliance with the FCC Rules could void the user's authority to operate this equipment.

<p>FCC Declaration or Conformity Compliance statement (Part 15):</p> <p>This device complies with Part 15 of the FCC rules. Operation is subject to the following two conditions: (1) this device may not cause harmful interference, and (2) this device must accept any interference received, including interference that may cause undesired operation. The party responsible for compliance to these rules is:</p> <p>GLOBAL Q INTERNATIONAL Ltd. 2700 E. Imperial Hwy Lynwood CA 90262 Ph:1-618-392-3456</p>

Important Safety Precautions

- 1) Read these instructions. 2) Keep these instructions. 3) Heed all warnings. 4) Follow all instructions.
- 5) Do not use this apparatus near water. 6) Clean only with dry cloth.
- 7) Do not block any ventilation openings. Install in accordance with the manufacturer's instructions.
- 8) Do not install near any heat sources such as radiators, heat registers, stoves, or other apparatus (including amplifiers) that produce heat.
- 9) Do not defeat the safety purpose of the polarized or grounding-type plug. A polarized plug has two blades with one wider than the other. A grounding type plug has two blades and a third grounding prong. The wide blade or the third prong are provided for your safety, If the provided plug does not fit into your outlet, consult an electrician for replacement of the obsolete outlet.
- 10) Protect the power cord from being walked on or pinched particularly at Plugs, convenience receptacles, and the point where they exit from the apparatus.
- 11) Only use attachments /accessories specified by the manufacturer.
- 12) Use only with the cart, stand, tripod, bracket, or table specified by the manufacturer, or sold with the apparatus. When a cart is used caution when moving the cart/apparatus combination to avoid injury tip-over. 
- 13) Unplug this apparatus during lightning storms or when unused for long periods of time.

Caution:

- 14) To reduce the risk of fire or electric shock, do not expose this apparatus to rain or moisture.
- 15) The mains plug is used as disconnect device, the disconnect device shall remain readily operable.
- 16) The AC receptacle shall be installed near the equipment and shall be easily accessible.
- 17) This product should never be placed in a built-in installation such as a bookcase or rack unless proper ventilation is provided or the manufacture's instructions have been adhered to.
- 18) The apparatus shall not be exposed to dripping or splashing and that no objects filled with liquid, such as vases, shall be placed on the apparatus.
- 19) Do not place any sources of danger on the apparatus (e.g. liquid filled objects, lighted candles).
- 20) Wall or Ceiling Mounting - The appliance should be mounted to a wall or ceiling only as recommended by the manufacturer.
- 21)  Never place the TV, remote control or batteries near open flames or other heat sources, including direct sunlight. To prevent the spread of fire, keep candles or other flames away from the TV, remote control and batteries at all times.
- 22) The USB terminal should be loaded with 0.5 A under normal operation.
To reduce the risk of electric shock do not perform any servicing.
- 23)  This equipment is a Class II or double insulated electrical appliance. It has been designed in such a way that it does not require a safety connection to electrical earth.
- 24) This apparatus should not be used at temperatures exceeding 113 degrees.

TV Buttons And Connections

TV Buttons

Note: The following is a representative example.

The position and arrangement of button may differ by model.

One Key:

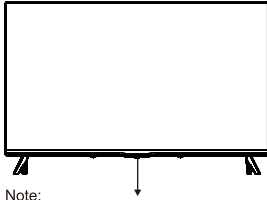

Note:
Press this button to turn on / off the TV.

Seven keys:

	Turn ON/OFF Power.
SOURCE	External Signal Input Selection.
MENU	Display Main MENU And Confirm MENU Item Selection.
CH+/-	Selecting Channel.
VOL+/-	Adjusting Volume.

Note:
Picture for reference purposes only.

Connections

Note: The following are the various connections available. The position and arrangement of connections differ by model.

	AV input External AV Signal Input		ANT 75 Connect the antenna/cable tv input (75/VHF/UHF)
	AV input External AV Signal Input		USB input Connect a USB device here to play its media files or to record programs via the PVR function.
	HDMI input Digital signal input from HDMI video connector.		OPTICAL output Connect the SPDIF receiver.
	RJ45 Connect the Internet.		HEADPHONE JACK Plug earphones into jack for private listening. Overrides speakers.



* Please discontinue use of any device using the USB mode before connecting, disconnecting or adjusting the HDMI or USB terminal ports.
Failure to do so can result in an electrostatic discharge that could cause damage to the TV and/or its operation.

External device connection diagram

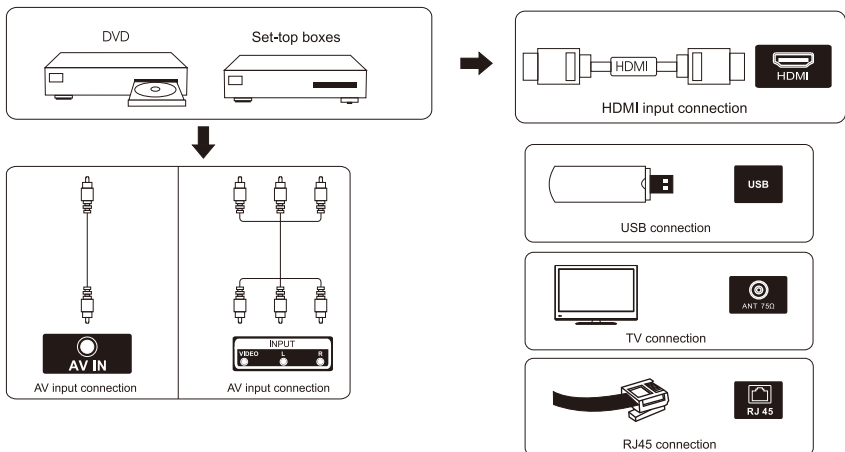

TV Install And Connect

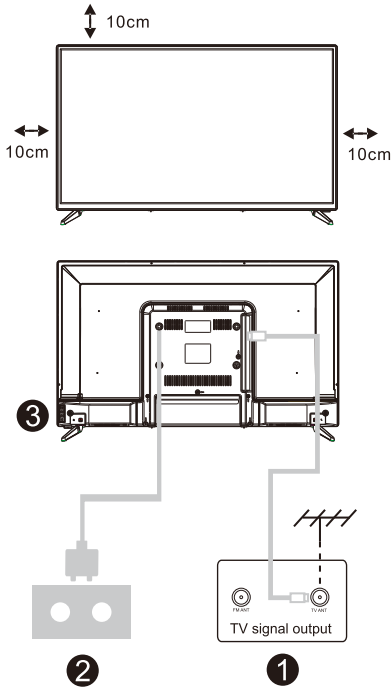

Setup your TV

1. Put your TV in a place that can support the weight of the TV.

To avoid danger, please do not assemble the TV near water or extreme heat (such as a furnace, light source, or candle.)

Do not block the ventilation on the back of the TV.

Connect signal source and power

2. Connect the antenna cable to the RF connection on the back or side of the TV, and/or the signal source HDMI cable to the HDMI input(s) on the rear or side of TV. Plug the TV into the wall power outlet (AC 100-240V~ 50/60Hz).

Turn on the TV

3. Connect the power supply, enter the standby mode (red light), press the power button of the TV or the power button on the remote control to turn on the TV.

Note:

Picture for reference purposes only.

TV Stand Installation Instructions

Stand Installation Guide

The TV is packaged with the TV stand separated from the cabinet. To setup the TV table stand, please carry out the installation according to the instructions below.

1. The panel can be scratched easily, so please:

Place a soft cloth on the table and place the TV face down on the cloth.

Note: Always unplug the AC cord first when installing/removing the stand.

2. Take the base. Please align the screw holes of the base and the TV, and then insert the screws into the holes on the base and tighten them.

Note: To ensure that the TV is stable, please tighten all screws.

The stand of some TV models is designed with snap-in type, easily installed by snapping into stand groove, instead of screw.

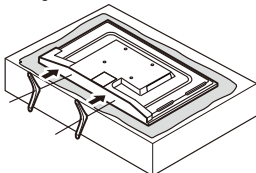

Please take note of the base direction:



The bottom view of the TV
(Front cabinet faces down)

(The illustration is for reference only, Please prevail in kind)

Suggestion:

To make it more convenient for base installation and to avoid any risk of scratches and damage, we advise you using the type of PH2 screwdriver.

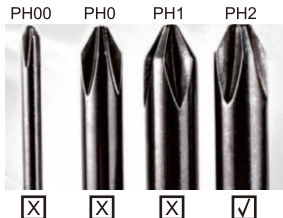

First Time Installation

First Time Installation

Enter the Home page after First Time install.
Press ◀/▶ button to Installation method.

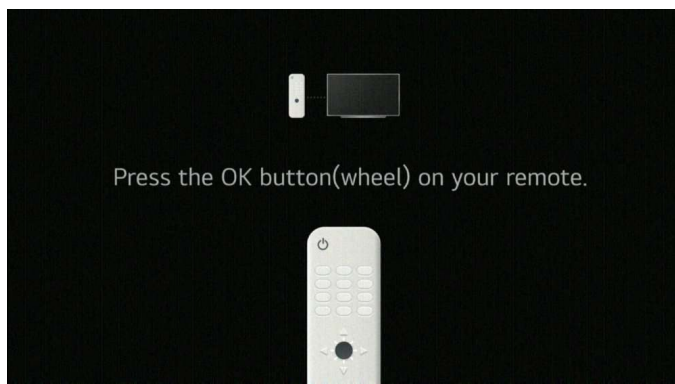

Home page

Home page

Enter the Home Page after first time installation.
In the list of apps, select the app you wish to select.

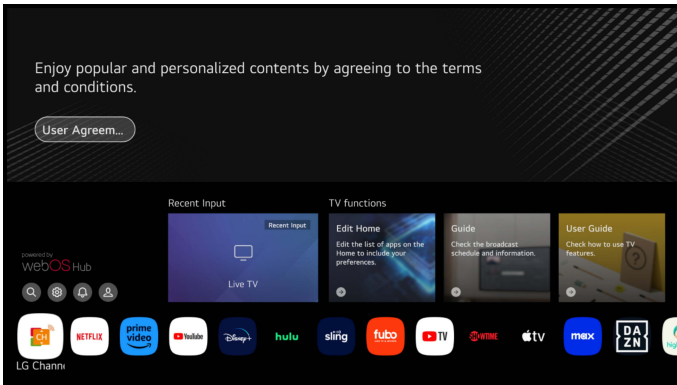

Using Home Dashboard

Select or control a device (mobile, external device, Home IoT Device) connected to the TV.
Press ▼ / ▲ / ◀ / ▶ button to select .

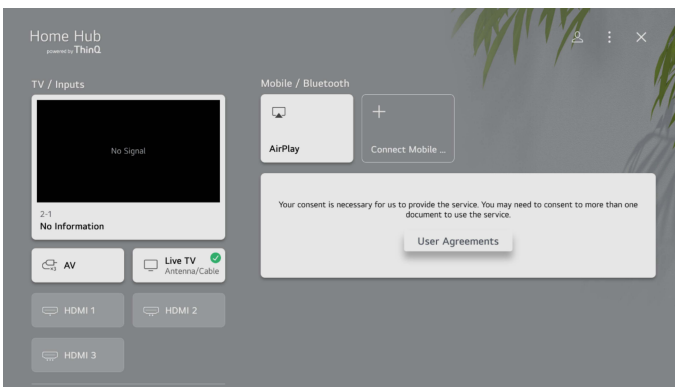

TV Setting

Press  button to enter the TV Setting Mode.

Press  /  button to highlight the desired menu icon , and press <OK> button to select.

Quick Settings



- 1.You can Select Picture Mode.
- 2.You can select Sound Mode
- 3.You can select Sound Out.
- 4.You can select Game Optimizer
- 5.You can add/delete the quick setting items or change the order.
- 6.You can set the backlight level from 0-100.
- 7.You can set up a Wi-Fi connection.
- 8.You can set the screen to close quickly.

TV Setting

All Settings

Press the ▼ / ▲ button to select the All Settings.

Press the <OK> key to enter the sub-menu.

Press ▼ / ▲ button to select Picture/Sound/General/Support.

Press ▼ / ▲ button to select Picture. Press <OK> button to enter sub-menu and setup.
(option: Select Mode/Aspect Ratio/Advanced Settings)



Picture Mode

Press ▼ / ▲ button to select the Picture Mode.

Press the <OK> key to enter the sub-menu.

Press ◀ / ▶ button to select Vivid/Standard/Basic/Cinema/Sports, and press <OK> button to setup.

Sound Mode

Press ▼ / ▲ button to select the Sound Mode.

Press the <OK> key to enter the sub-menu.

Press ◀ / ▶ button to select Standard/ Cinema/ Clear Voice/ Sports/ Music, and press <OK> button to setup.

Sound Out Mode

Press the ▼ / ▲ button to select the Sound Out Mode.

Press the <OK> key to enter the sub-menu.

Press ◀ / ▶ button to select TV Speaker/ Bluetooth Device/ Mobile Device/ Optical Out Device/ HDMI (ARC) Device/ Wired Headphones/ Optical Out Device+TV Speaker/ Wired Headphones + TV Speaker, and press <OK> button to setup.

Game Optimiser

Press ▼ / ▲ button to select Game Optimiser.

Network

If you configure settings for your network, you can use various services such as online contents and applications.

Wired Connection(Ethernet)

Press ▼ / ▲ button to select Wired Connection(Ethernet).

Press <OK> button to enter sub-menu and setup.

Wi-Fi Connection

Press ▼ / ▲ button to select Wi-Fi Connection. Press <OK> button to enter sub-menu and setup.

Media

Connect a USB storage device (USB HOD, USB stick) to the USB port on the TV to enjoy the content files stored on the USB storage device.

Press ▼ / ▲ button on to select Photo & Video/Photo/Video/Music.

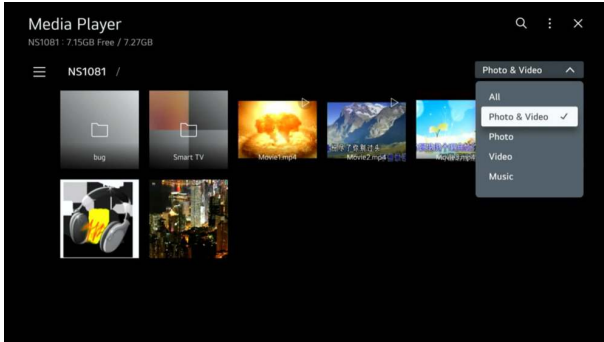
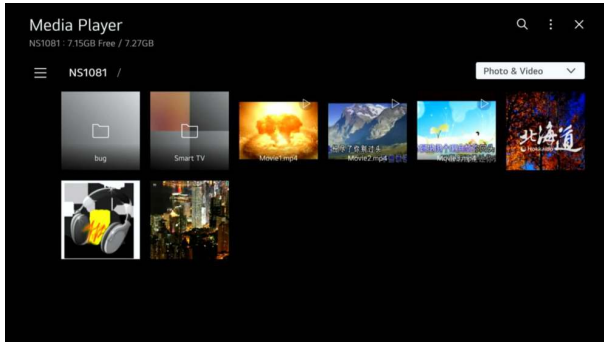

Photo and Video

You can view photos and videos using the Photo & Video app.



Photo

Selecting a photo in the Photo & Video app activates the photo player. You can view your saved photos.

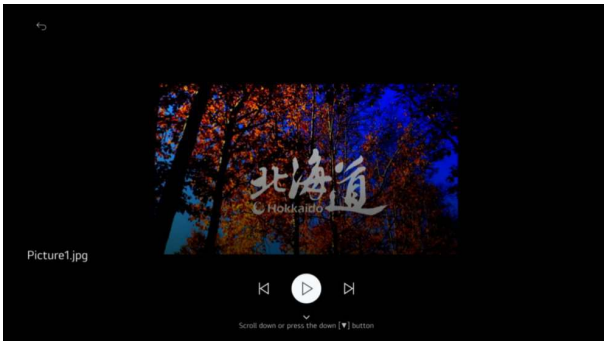

Media

Video

Selecting a video in the Photo & Video app activates the video player. You can view your saved videos.

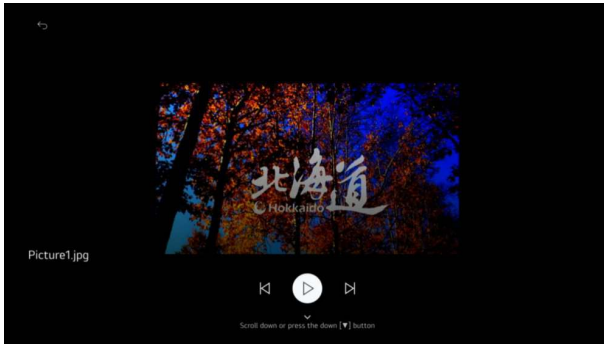

Music

You can play music conveniently by selecting the music files saved in the Music app or by selecting the music player icon during content playback in apps such as Photo & Video.

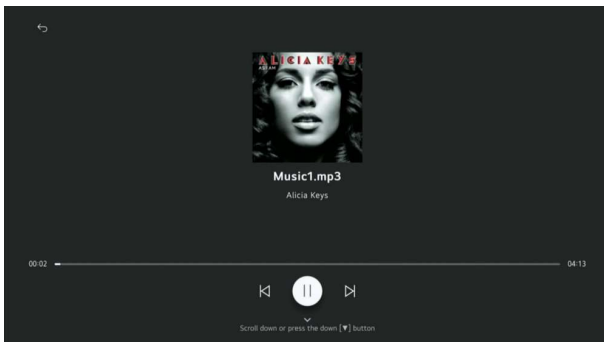
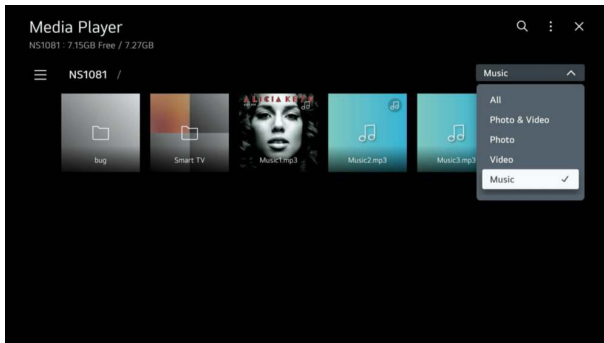

Help

No power	<ul style="list-style-type: none"> ● Check if the AC cord of TV is plugged in. If there's still no power, please disconnect the plug, and reconnect to the outlet after 60 seconds. Turn the power back on.
Signal not received properly	<ul style="list-style-type: none"> ● Double or phantom images may appear on your TV if there are high buildings or mountains close to where you are. You can adjust the image thru manual operation: consult antenna instruction manual adjust the direction of the external antenna. ● If you use an indoor antenna, signal reception may be more difficult under certain circumstances. Adjust the direction of the antenna for optimum reception. If this does not improve reception, you may have to switch to an external antenna.
No picture	<ul style="list-style-type: none"> ● Check if the antenna at the back of the TV is connected properly. ● View other channels to see if the problem still occurs.
Video appears with no audio	<ul style="list-style-type: none"> ● Try increasing the volume. ● Check if the TV's sound is on mute.
Audio is present, but video does not appear or is discolored	<ul style="list-style-type: none"> ● Try adjusting the contrast and brightness.
Static noise affects video and audio quality	<ul style="list-style-type: none"> ● Check if the antenna at the back of the TV is connected properly.
Broken lines on screen	<ul style="list-style-type: none"> ● Electrical appliances such as hair dryers or vacuums etc. may be interfering with your TV set. Switch these appliances off.
Remote doesn't work	<ul style="list-style-type: none"> ● Try using the remote in a shorter distance from the TV. Check if the placement of the batteries is correct, or try using new batteries with the remote control. ● The TV will go into Standby mode if it receives no response in a few minutes.
No video (PC mode)	<ul style="list-style-type: none"> ● Please check if the cable is connected to the HDMI port correctly, or if the cable is bent or damaged.
Vertical line blinking (PC Mode)	<ul style="list-style-type: none"> ● Enter the main menu, and adjust the vertical placement to eliminate the vertical line.
Horizontal tearing (PC Mode)	<ul style="list-style-type: none"> ● Adjust the horizontal placement of the screen to clear any horizontal lines.
Screen is too bright or dark (PC Mode)	<ul style="list-style-type: none"> ● Adjust the brightness or contrast in the main menu.
No response from the PC	<ul style="list-style-type: none"> ● Check if the PC's display resolution is set to a compatible resolution for the TV.
Lines appearing when a device is connected to the RCA port	<ul style="list-style-type: none"> ● Make sure you are using a cable which is not bent or damaged.
Problems are unresolved	<ul style="list-style-type: none"> ● Unplug the power cable and wait for 30 seconds, then reconnect to the socket. If problems still persist, do not attempt to repair the TV by yourself. Kindly contact customer service 618-392-3456.

Do not leave your TV displaying a static image, whether it is from a paused video, menu screen, etc. for an extended period of time, doing so will damage the display and may cause image burn-in.

Specifications

Screen Size	power Consumption	Main accessories
24"	30W/36W	User's manual x1 Remote controller x1 Power cord x1 AAA Batteries x2 (Optional)
28"	31W/36W	
32"	40W/56W	
39"/40"	60W/70W/90W	
42"	65W/70W/90W	
43"	70W/80W/90W	
50"	100W/108W/120W	
55"	110W/118W/135W	
58"/60"	120W/135W/160W	
65"	160W/165W/190W	
75"	185W/230W/250W/260W	

★ LIFE TIME : 60,000 Hrs

	Operation Frequency	Transmitting Power
WiFi	2400~2483.5	Less Than 100mW

WARNING

Never place a television set in an unstable location. A television set may fall, causing serious personal injury or death. Many injuries, particularly to children, can be avoided by taking simple precautions such as:

1. Using cabinets or stands recommended by the manufacturer of the television set.
2. Only use furniture that can safely support the television set.
3. Ensure the television set is not overhanging the edge of the supporting furniture.
4. Do not place the television set on tall furniture (for example, cupboards or bookcases) without anchoring both the furniture and the television set to a suitable support.
5. Do not place the television set on cloth or other materials that may be located between the television set and supporting furniture.
6. Educate children about the dangers of climbing on furniture to reach the television set or its controls.

If your existing television set is being retained and relocated, the same considerations as above should be applied.

Wall-mounted screw: 22-24inch M4, 28-70inch M6, 75inch M8

Note: don't hang at an angle to avoid the risk of falling off.

This user manual for reference only

Remote control



: ON/OFF.

: Switch to TV.

: Search.

: Enable/disable CC or subtitles.

: Enters the Quick Settings menu.

: Selects an input source.

0-9: Number selection key.

—/LIST: The QUICK ACCESS edit screen appears.

...: It displays the additional buttons on the remote control.

VOL: It adjusts the volume level.

: You can change the programme.

FAV: Program preferences.

GUIDE: Displays channel guide where available.

: Mutes the sound.

: Play.

: Displays the Home menu.

: Pause.

BACK : Move to the previous step.

EXIT: Closes the menu.

: Select current option that is highlighted.

: RIGHT/LEFT UP/DOWN buttons to navigate the on-screen menus.

: Show program information.

SAP: Audio Language.

MOVIES: Search Movies.

REC: Launch Record.

: Launch Live Playback.

NETFLIX: go to NETFLIX.

: go to prime video.

: Corresponds to various color functions in the menu or teletext.

Serial # _____

Date of Purchase _____

Place of Purchase _____

Your receipt is required to verify your proof of purchase, please attach a copy of your receipt here for your records.



limited **WARRANTY**

Elitelux Technologies warrants this product to be free from manufacturing defects in material and workmanship under normal use and conditions for a period of 1 year from date of original purchase.

Should service be necessary under this warranty for any reason due to a manufacturing defect or malfunction during the first 12 months from date of original purchase, Elitelux will provide carry-in service for units with a screen size of 49 inches or below, and in-home service for units 50 inches or greater in screen size by a Elitelux authorized Independent Service Center at no charge. Also, if an original part fails due to manufacturing defect in material and workmanship within one year from date of original purchase we will replace the defective part, provided the defect or malfunction is verified along with dated proof of purchase.

There are Elitelux authorized Independent Service Centers located throughout the country. For the one nearest you, DIAL: 1-618-392-3456. Elitelux will not be liable for damages incurred in shipment of the unit. If there are no Elitelux authorized Independent Service Centers in your area please call for assistance.

Note: This warranty is void if the product is:

- (a) Damaged through negligence, misuse, abuse, or accident.
- (b) Used in a commercial application or rentals.
- (c) Modified or repaired by anyone other than an Independent Service Center authorized by Elitelux to effect warranty repairs to the class of product.
- (d) Damaged because it is improperly connected to the equipment of other manufacturers.

This warranty does not cover:

- (a) Damage to equipment not properly connected to the product.
- (b) Costs incurred in the shipping of the product to a Elitelux authorized Independent Service Center.
- (c) Damage or improper operation of unit caused by customer abuse, misuse, negligence, or failure to follow operating instructions provided with the product.
- (d) Ordinary adjustments to the product which can be performed by customer as outlined in the owner's manual.
- (e) Signal reception problems caused by external antenna or cable systems.

THIS WARRANTY IS NON TRANSFERABLE AND APPLIES ONLY TO THE ORIGINAL PURCHASER AND DOES NOT EXTEND TO SUBSEQUENT OWNERS OF THE PRODUCT. ANY APPLICABLE IMPLIED WARRANTIES, INCLUDING THE WARRANTY OF MERCHANTABILITY, ARE LIMITED IN DURATION TO A PERIOD OF THE EXPRESS WARRANTY AS PROVIDED HEREIN BEGINNING WITH THE DATE OF ORIGINAL PURCHASE AT RETAIL AND NO WARRANTIES, WHETHER EXPRESS OR IMPLIED SHALL APPLY TO THIS PRODUCT THEREAFTER. ELITELUX MAKES NO WARRANTY AS TO THE FITNESS OF THE PRODUCT FOR ANY PARTICULAR PURPOSE AND USE.

UNDER NO CIRCUMSTANCES SHALL ELITELUX BE LIABLE FOR ANY LOSS, DIRECT, INDIRECT, INCIDENTAL, SPECIAL, OR CONSEQUENTIAL DAMAGE ARISING OUT OF OR IN CONNECTION WITH THE USE OF THIS PRODUCT.

IN THE UNITED STATES OF AMERICA THIS WARRANTY GIVES YOU SPECIFIC LEGAL RIGHTS, HOWEVER YOU MAY HAVE OTHER RIGHTS WHICH MAY VARY FROM STATE TO STATE. SOME STATES DO NOT ALLOW LIMITATION ON IMPLIED WARRANTIES OR EXCLUSION OF CONSEQUENTIAL DAMAGE, THEREFORE THESE RESTRICTIONS MAY NOT APPLY TO YOU.

ELITELUX TECHNOLOGIES, INC.
3471 N. Union Drive
Olney, IL 62450
618-392-3456