

# Refrigerator

---

## User manual

RZ40H\*\*\*\*\*

---

Free Standing Appliance

**SAMSUNG**

# Contents

---

<b>Safety information</b>	<b>4</b>
What you need to know about the safety instructions	4
Important safety symbols and precautions:	5
State of California Proposition 65 Warning	5
Important safety precautions	5
Severe warning signs for transportation and site	7
Critical installation warnings	7
Installation cautions	9
Critical usage warnings	9
Usage cautions	12
Cleaning cautions	13
Critical disposal warnings	14
<b>Installation</b>	<b>15</b>
Refrigerator at a glance	15
Step-by-step installation	16
<b>Operations</b>	<b>21</b>
Main panel	21
Special features	24
<b>Maintenance</b>	<b>27</b>
Door reversal	27
Auto Open Door option touch sensor reversible (applicable models only)	39
Reversing the door handle position (applicable models only)	40
Handle and care	42
Cleaning	43
Replacement	43
<b>Troubleshooting</b>	<b>44</b>
General	44
Do you hear abnormal sounds from the refrigerator?	46
<b>LIMITED WARRANTY (U.S.A.)</b>	<b>48</b>
SAMSUNG REFRIGERATOR	48

---

<b>Warranty Information (CANADA)</b>	<b>51</b>
If your refrigerator needs service	51
Limited Warranty for Original Purchaser	51
Obligation to the Original Owner	51
Exclusions of the Warranty	52
NOTICE TO QUEBEC CONSUMERS - Warranty of Availability of Replacement Parts, Repair Services, and Maintenance and Repair Information	52
DISCLAIMER OF LIABILITY	53

# Safety information

---

Before using your new Samsung Refrigerator, please read this manual thoroughly to ensure that you know how to operate the features and functions that your new appliance offers safely and efficiently.

## What you need to know about the safety instructions

---

- This appliance is not intended for use by persons (including children) with reduced physical, sensory or mental capabilities, or lack of experience and knowledge, unless they have been given supervision or instruction concerning use of the appliance by a person responsible for their safety. Children should be supervised to ensure that they do not play with the appliance.
- Because the following instructions cover various models, the characteristics of your refrigerator may differ slightly from the refrigerator described in this manual.
- If you have any question, contact us at 1-800-SAMSUNG or find help and information online at [www.samsung.com](http://www.samsung.com).
- Refrigerant squirting out of the pipes could ignite or cause an eye injury. When refrigerant leaks from the pipe, avoid any naked flames and move anything flammable away from the product and ventilate the room immediately.
  - Failing to do so may result in fire or explosion.
- Improper use of the grounding plug can result in a risk of electric shock. If it is necessary to use an extension cord, use only a 3-wire extension cord that has a 3-blade grounding plug and a 3-slot receptacle that will accept the plug on the appliance. The marked rating of the extension cord should be AC 115-120 V, 10 A, or more. If a grounding adapter is used, make sure the receptacle box is fully grounded.

---

## Important safety symbols and precautions:

---

Please follow all safety instructions in this manual. This manual uses the following safety symbols.

### **WARNING**

Hazards or unsafe practices that may result in severe personal injury, property damage, and/or death.

### **CAUTION**

Hazards or unsafe practices that may result in severe personal injury and/or property damage.

### **NOTE**

Useful information that helps users understand or benefit from the refrigerator.

These warning signs are here to prevent injury to you and others.

Please follow them carefully.

After reading this section, keep it in a safe place for future reference.

---

## State of California Proposition 65 Warning

---

### **WARNING**

Cancer and Reproductive Harm - [www.P65Warnings.ca.gov](http://www.P65Warnings.ca.gov).

---

## Important safety precautions

---



**WARNING; Risk of fire / flammable materials**

### **WARNING**

- R-600a is used as a refrigerant. This product contains flammable gas (Refrigerant R-600a), contact your local authority in regard to safe disposal of this product.
- In order to avoid the creation of a flammable gas-air mixture if a leak in the refrigerating circuit occurs, the size of the room in which the appliance may be sited depends on the amount of refrigerant used. The room must be 35.3 ft<sup>3</sup> in size for every 8 g of R-600a refrigerant inside the appliance.

# Safety information

---

- The installation location should not be exposed to direct sunlight and not placed near any electric appliance or heat source, e.g. stove, oven or hob, radiator, etc.
- If you use two products side by side, for safety reason, be sure to use certified products in explosive gas atmospheres.
- Never start up an appliance showing any signs of damage. If in doubt, consult your dealer.
- If the supply cord is damaged, it must be replaced by the manufacturer, its service agent or similarly qualified persons in order to avoid a hazard.
- The socket must be easily accessible so that the appliance can be quickly disconnected from the supply in an emergency. It must be outside the area of the rear of the appliance.
- Do not store explosive substances such as aerosol cans with a flammable propellant in this appliance.
- New hose-sets supplied with the appliance are to be used and that old hose-sets should not be reused.
- When positioning the appliance, ensure the supply cord is not trapped or damaged.
- Do not locate multiple portable socket-outlets or portable power supplies at the rear of the appliance.

## **WARNING**

- Fill with potable water only.
- Keep ventilation openings, in the appliance enclosure or in the built-in structure, clear of obstruction.
- Do not use mechanical devices or other means to accelerate the defrosting process, other than those recommended by the manufacturer.
- Do not damage the refrigerant circuit.
- Do not use electrical appliances inside the food storage compartments of The appliance, unless they are of the type recommended by the manufacturer.
- Connect to potable water supply only.

## **WARNING**

- Risk of child entrapment. Before you throw away your old refrigerator or freezer:
  - Take off the doors.
  - Leave the shelves in place so that children may not easily climb inside.

**This appliance is intended to be used in household and similar applications such as**

- staff kitchen areas in shops, offices and other working environments;
- farm houses and by clients in hotels, motels and other residential type environments;
- bed and breakfast type environments;
- catering and similar non-retail applications.

---

## Severe warning signs for transportation and site

---

### **WARNING**

- When transporting and installing the appliance, care should be taken to ensure that no parts of the refrigerating circuit are damaged.
  - Refrigerant leaking from the pipe work could ignite or cause an eye injury. If a leak is detected, avoid any naked flames or potential sources of ignition and air the room in which the appliance is standing for several minutes.
  - This appliance contains a small amount of isobutane refrigerant (R-600a), a natural gas with high environmental compatibility that is, however, also flammable.

## Critical installation warnings

---

### **WARNING**

- Do not install the refrigerator in a damp location or place where it may come in contact with water.
  - Deteriorated insulation on electrical parts may cause an electric shock or fire.
- Do not place this refrigerator in direct sunlight or expose it to the heat from stoves, room heaters, or other appliances.
- Do not plug several appliances and the refrigerator into the same multiple power strip. The refrigerator should always be plugged into its own individual electrical outlet which has a voltage rating that matches the voltage listed on the refrigerator's rating plate.
  - This provides the best performance and also prevents overloading of house wiring circuits, which could overheat the wires and cause a fire hazard.
- If the wall socket is loose, do not insert the power plug.
  - There is a risk of electric shock or fire.
- Do not use a power cord that has cracks or abrasion damage along its length or at either end.
- Do not bend the power cord excessively or place heavy objects on it.
- Do not pull or excessively bend the power cord.
- Do not twist or tie the power cord.
- Do not hook the power cord over a metal object, place a heavy object on the power cord, insert the power cord between objects, or push the power cord into the space behind the appliance.
- When moving the refrigerator, be careful not to roll over or damage the power cord.
  - This may result in an electric shock or fire.
- Never unplug your refrigerator by pulling on the power cord. Always grip the plug firmly and pull straight out from the outlet.
  - Damage to the cord may cause a short-circuit, fire, and/or electric shock.
- Do not install this appliance near a heater or flammable material.
- Do not install this appliance in a location where gas may leak.
  - This may result in an electric shock or fire.
- This refrigerator must be properly located and installed in accordance with the instructions in this manual before you use it.

# Safety information

---

- Connect the power plug in the proper position with the cord hanging down.
  - If you connect the power plug upside down, the wire can get cut off and cause a fire or electric shock.
- Make sure that the power plug is not crushed or damaged by the back of the refrigerator.
- Keep the packing materials out of reach of children.
  - There is a risk of death from suffocation if a child puts the packing materials on his or her head.
- The appliance must be positioned so that the plug is accessible after installation.
  - Failing to do so may result in an electric shock or fire due to electric leakage.
- Do not install this appliance in a humid, oily or dusty location, or in a location exposed to direct sunlight or to water (rain drops).
  - Deteriorated insulation on electrical parts may cause an electric shock or fire.
- If large amounts of dust or water enter the refrigerator, disconnect the power plug and contact a Samsung Electronics service center.
  - Otherwise there is a risk of fire.
- Do not stand on top of the appliance or place objects (such as laundry, lighted candles, lighted cigarettes, dishes, chemicals, metal objects, etc.) on the appliance.
  - This may result in an electric shock, fire, problems with the product, or injury.
- You need to remove all the protective plastic film before you initially plug the product in.
- Children should be supervised to ensure that they do not play with the snap rings used for door adjustment or the water tube clips.
  - There is risk of death by suffocation if a child swallows a snap ring or water tube clip. Keep the snap rings and water tube clips out of children's reach.
- The refrigerator must be safely grounded.
  - Always make sure that you have grounded the refrigerator before attempting to investigate or repair any part of the appliance. Power leakages can cause severe electric shock.
- Never use gas pipes, telephone lines, or other potential lightning attractors as an electrical ground.
  - You must ground the refrigerator to prevent any power leakages or electric shocks caused by current leakage from the refrigerator.
  - Current leakage may result in an electric shock, fire, explosion, or problems with the product.
- Plug the power plug into the wall socket firmly. Do not use a damaged power plug, damaged power cord, or loose wall socket.
  - This may result in an electric shock or fire.
- Only a qualified technician or service company should be allowed to change the fuse in the refrigerator.
  - Failing to do so may result in an electric shock or personal injury.

---

## Installation cautions

---

### CAUTION

- Allow sufficient space around the refrigerator and install it on a flat surface.
  - Keep the ventilation space in the appliance enclosure or mounting structure clear of obstructions.
- After you have installed the refrigerator and turned it on, allow the appliance to stand for 2 hours before loading it with food.
- It is strongly recommended you have a qualified technician or service company install the refrigerator.
  - Failing to do so may result in an electric shock, fire, explosion, problems with the product, or injury.
- Overloading one door may make the refrigerator fall, causing physical injury.

## Critical usage warnings

---

### WARNING

- Do not insert the power plug into a wall socket with wet hands.
  - This may result in an electric shock.
- Do not store articles on the top of the appliance.
  - When you open or close the door, the articles may fall and cause personal injury and/or material damage.
- Do not insert hands, feet, or metal objects (such as chopsticks, etc.) into the bottom or the back of the refrigerator.
  - This may result in an electric shock or injury.
  - Any sharp edges may cause a personal injury.
- Do not touch the inside walls of the freezer or products stored in the freezer with wet hands.
  - This may cause frostbite.
- Do not put a container filled with water on the refrigerator.
  - If spilled, there is a risk of fire or electric shock.
- Do not keep volatile or flammable objects or substances (benzene, thinner, propane gas, alcohol, ether, LP gas, and other such products) in the refrigerator.
  - This refrigerator is for storing food only.
  - This may result in fire or explosion.
- Children should be supervised to ensure that they do not play with the appliance.
  - Keep fingers out of “pinch point” areas. Clearances between the doors and cabinet are necessarily small. Be careful when you open the doors if children are in the area.
- Do not let children hang on the door or door bins. A serious injury may occur.
- Do not let children go inside the refrigerator. They could become trapped.
- Do not insert your hands into the area under the appliance.
  - Any sharp edges may cause personal injury.

# Safety information

---

- Do not store pharmaceutical products, scientific materials, or temperature sensitive products in the refrigerator.
  - Products that require strict temperature controls must not be stored in the refrigerator.
- Do not place or use electrical appliances inside the refrigerator/freezer, unless they are of a type recommended by the manufacturer.
- If you smell smoke, pull out the power plug immediately, and then contact a Samsung Electronics service center.
- If large amounts of dust or water enter the refrigerator, disconnect the power plug and contact your Samsung Electronics service center.
  - Otherwise there is a risk of fire.
- Do not let children step on a drawer.
  - The drawer may break and cause them to slip.
- Do not leave the doors of the refrigerator open while the refrigerator is unattended and do not let children enter the refrigerator.
- Do not allow babies or children to go into a drawer.
  - It can cause death from suffocation by entrapment or personal injury.
- Do not overfill the refrigerator with food.
  - When you open the door, an item may fall out and cause personal injury or material damage.
- Do not spray volatile material such as insecticide onto the surface of the appliance.
  - As well as being harmful to humans, it may also result in an electric shock, fire, or problems with the product.
- Never put fingers or any objects into the water dispenser outlet, ice chute, or ice maker bucket.
  - It may cause a personal injury or material damage.
- Do not use or place any substances sensitive to temperature such as flammable sprays, flammable objects, dry ice, medicine, or chemicals near or inside the refrigerator.
- Do not use a hair dryer to dry the inside of the refrigerator. Do not place a lighted candle in the refrigerator to remove bad odors.
  - This may result in an electric shock or fire.
- Fill the water tank and ice cube trays with potable water only (tap water, mineral water, or purified water).
  - Do not fill the tank with tea, juice, or a sports drink. They can damage the refrigerator.
- Do not stand on top of the appliance or place objects (such as laundry, lighted candles, lighted cigarettes, dishes, chemicals, metal objects, etc.) on the appliance. This may result in an electric shock, fire, problems with the product, or injury. Do not put a container filled with water on the appliance.
  - If spilled, there is a risk of fire or electric shock.
- Never stare directly at the UV LED lamp for long periods of time.
  - This may result in eye strain due to the ultraviolet rays.
- Do not put a fridge shelf into the refrigerator upside down. The shelf stopper will not work.
  - The glass shelf could fall and cause personal injury.
- Keep fingers out of “pinch point” areas. Clearances between the doors and cabinet are necessarily small. Be careful when you open the doors if children are in the area.

- 
- If a gas leak is detected, avoid any naked flames or potential sources of ignition, and air the room in which the appliance is standing for several minutes.
    - Do not touch the appliance or power cord.
    - Do not use a ventilating fan.
    - A spark may result in an explosion or fire.
  - Use only the LED Lamps provided by the manufacturer or its service agents.
  - Bottles should be stored tightly together so that they do not fall over or out.
  - This product is intended only for the storage of food in a domestic environment.
  - Never put fingers or any objects into the water dispenser outlet, ice chute, or ice maker bucket.
    - This can cause a personal injury or material damage.
  - Do not attempt to repair, disassemble, or modify the refrigerator yourself.
    - Unauthorized modifications can cause safety problems. To reverse an unauthorized modification, we will charge the full cost of parts and labor.
  - Do not use any fuse (such as cooper, steel wire, etc.) other than a standard fuse.
  - If your refrigerator needs to be repaired or reinstalled, contact your nearest Samsung service center.
    - Failing to do so may result in an electric shock, fire, problems with the product, or injury.
  - If the interior or exterior LED lamp has gone out, contact your nearest Samsung service center.
  - If the refrigerator emits a burning smell or smoke, unplug the refrigerator immediately and contact a Samsung service center.
    - Failing to do so may result in an electric or fire hazards.
  - Pull the power plug out of the socket before changing the interior lamps of the refrigerator.
    - Otherwise, there is a risk of electric shock.
  - If you experience difficulty changing a non-LED light, contact a Samsung service center.
  - If the product is equipped with LED lamps, do not disassemble the Lamp Covers and LED lamps yourself.
    - Contact a Samsung service center.
  - Plug the power plug into the wall socket firmly.
  - Do not use a damaged power plug, damaged power cord, or loose wall socket.
    - This may result in an electric shock or fire.

# Safety information

---

## Usage cautions

---

### CAUTION

- Do not re-freeze frozen foods that have thawed completely.
- Use only the ice maker provided with the refrigerator.
- To get the best performance from the product:
  - Do not place food too close to the vents at the rear of the refrigerator as this can obstruct free air circulation in the refrigerator compartment.
  - Wrap food up properly or place it in airtight containers before putting it into the refrigerator.
  - Please observe maximum storage times and expiration dates of frozen goods.
- Do not put glass containers or bottles or carbonated beverages into the freezer.
  - The container may freeze and break, and this may result in injury.
- Service Warranty and Modification.
  - Any changes or modifications performed by a 3rd party on this finished appliance are not covered under Samsung warranty service, nor is Samsung responsible for safety issues that result from 3rd party modifications.
- Do not block the air vents inside the refrigerator.
  - If the air vents are blocked, especially with a plastic bag, the refrigerator can be over cooled. If a cooling period lasts too long, the water filter may break and cause water leakage.
- If the refrigerator is disconnected from the power supply, you should wait for at least five minutes before plugging it back in.
- If large amounts of water enter the refrigerator, pull out the power plug and contact a Samsung service center.
- Do not strike or apply excessive force to any glass surface.
  - Broken glass may result in a personal injury and/or property damage.
- Fill the water tank and ice cube trays with potable water only (tap water, mineral water, or purified water).
  - Do not fill the tank with tea, juice, or a sports drink. They can damage the refrigerator.
- If the refrigerator is flooded, shut off the power to the refrigerator and contact your nearest Samsung service center.
  - There is a risk of electric shock or fire.
- Do not keep vegetable oil in your refrigerator's door bins. The oil can solidify, making it foul-tasting and difficult to use. In addition, the open container can leak and the leaked oil can cause the door bin to crack. After opening an oil container, it is best to keep the container in a cool and shaded place such as a cupboard or pantry.
  - Examples of vegetable oil: olive oil, corn oil, grape-seed oil, etc.

---

## Cleaning cautions

---

### CAUTION

- Do not spray water directly on the inside or outside of the refrigerator.
  - There is a risk of fire or electric shock.
- Do not use a hair dryer to dry the inside of the refrigerator.
- Do not place a lighted candle in the refrigerator to remove bad odors.
  - This may result in an electric shock or fire.
- Do not spray cleaning products directly on the display.
  - Printed letters on the display may come off.
- If any foreign substance such as water has entered the appliance, unplug the power plug and contact your nearest Samsung service center.
  - Failing to do so may result in an electric shock or fire.
- Use a clean, dry cloth to remove any foreign matter or dust from the power plug blades. Do not use a wet or damp cloth when cleaning the plug.
  - Otherwise, there is a risk of fire or electric shock.
- Do not clean the appliance by spraying water directly onto it.
- Do not use benzene, thinner, or Clorox (bleach) to clean the refrigerator.
  - They may damage the surface of the appliance and may cause a fire.
- Never put fingers or any objects into the dispenser outlet.
  - This can cause a personal injury or material damage.
- Before cleaning or performing maintenance, unplug the appliance from the wall socket.
  - Failing to do so may result in an electric shock or fire.
- Use a clean sponge or soft cloth and a mild detergent in warm water to clean the refrigerator.
- Do not use abrasive or harsh cleansers such as window sprays, scouring cleansers, flammable fluids, muriatic acid, cleaning waxes, concentrated detergents, bleaches, or cleansers containing petroleum products on exterior surfaces (doors and cabinet), plastic parts, door and interior liners, and gaskets.
  - These can scratch or damage the material.
- Do not clean glass shelves or covers with warm water when they are cold. Glass shelves and covers may break if exposed to sudden temperature changes or impacts such as bumping or dropping.

# Safety information

---

## Critical disposal warnings

---

### **WARNING**

- Children trapped inside a refrigerator can hurt themselves or suffocate to death.
- Please dispose of the packaging material from this product in an environmentally friendly manner.
- Ensure that none of the pipes on the back of the refrigerator are damaged prior to disposal.
- This product contains R-600a, a flammable gas, which is used as the refrigerant. Contact your local authorities regarding safe disposal of this product.
- When disposing of this refrigerator, remove the door/door seals and door latch so that small children or animals cannot become trapped inside. Children should be supervised to ensure that they do not play with the appliance.
  - If trapped inside, the child could be injured or suffocate to death.
- Cyclopentane is used in the insulation. The gases in the insulation material require a special disposal procedure. Please contact your local authorities in regard to the environmentally safe disposal of this product.
- Keep all packaging materials well out of the reach of children, as packaging materials can be dangerous to children.
  - If a child places a bag over his or her head, the child could suffocate.

# Installation

---

Follow these instructions carefully to ensure a proper installation of this refrigerator and to prevent accidents before using it.

## **WARNING**

- Use the refrigerator only for its intended purpose as described in this manual.
- Any servicing must be performed by a qualified technician.
- Dispose of the product packaging material in compliance with the local regulations.
- To prevent electric shock, unplug the power cord before servicing or replacements.

## Refrigerator at a glance

---

The actual image and provided component parts of the refrigerator may differ, depending on the model and the country.

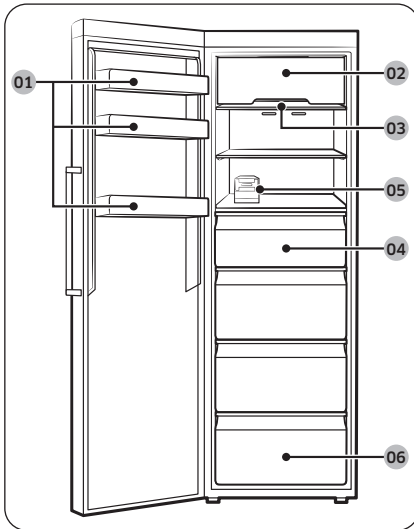

- 01** Door bin
- 02** Top shelf cover \*
- 03** Freezer shelf
- 04** Freezer drawer
- 05** Twist ice maker \*
- 06** Bottom drawer

\* Applicable models only

## **NOTE**

- For best energy efficiency, make sure all of shelves, drawers, and baskets are placed in their original position.

# Installation

---

## Step-by-step installation

---

### STEP 1 Select a site

---

#### Site requirements:

- Solid, level surface without carpeting or flooring that may obstruct ventilation
- Away from direct sunlight
- Adequate room for opening and closing the door
- Away from a heat source
- Room for maintenance and servicing
- Temperature range: between 38 °F (3 °C ) and 110 °F (43 °C)

#### Clearance

See the pictures and table below for space requirements for installation.

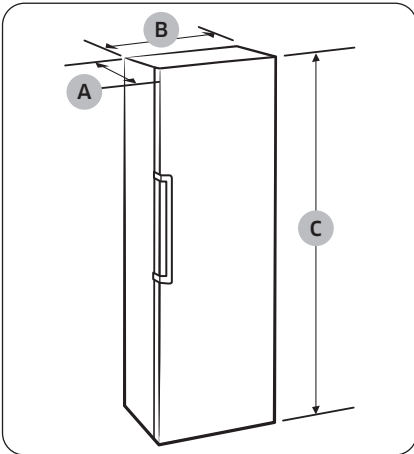

Depth "A"	27 <sup>3</sup> / <sub>8</sub> " (694 mm)
Width "B"	23 <sup>3</sup> / <sub>8</sub> " (595 mm)
Overall Height "C"	73 <sup>1</sup> / <sub>8</sub> " (1858 mm)

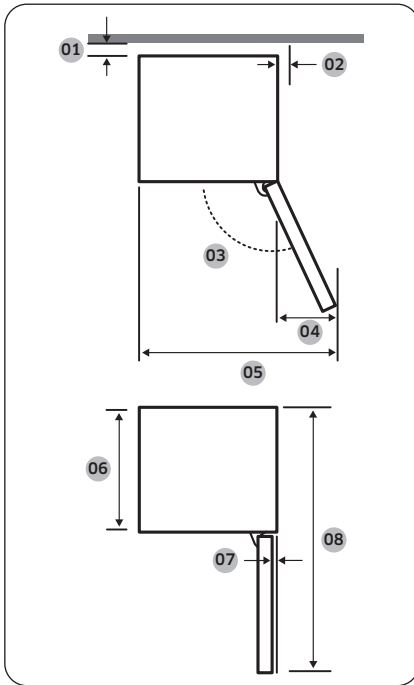

	Bar handle type
01	more than 2" (50 mm) recommended
02	more than 12 mm recommended
03	105°
04	7 1/8" (181.5 mm)
05	30 5/8" (776.5 mm)
06	22 5/8" (575 mm)
07	2/8" (5.5 mm)
08	47" (1194 mm)

**NOTE**

The measurements in the above table may differ, depending on the measuring method.

# Installation

---

## STEP 2 Spacing

---

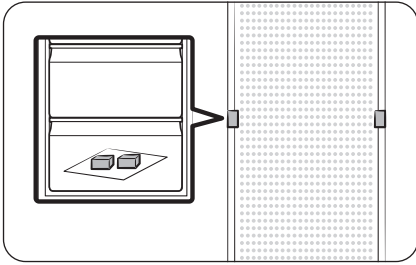

1. Open the door and locate the provided spacers (x2).
2. Unpack both spacers and attach them to the rear of the refrigerator as shown. They help ventilate air to the rear wall and save power consumption.

## STEP 3 Flooring

---

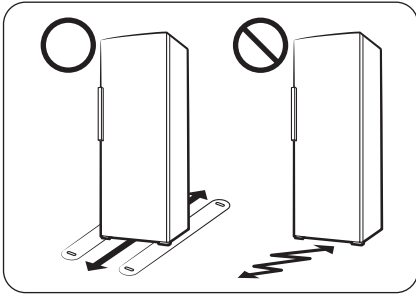

- The surface to install the refrigerator must support a fully loaded refrigerator.
- To protect the floor, put a large piece of cardboard on each foot of the refrigerator.
- Once the refrigerator is in its final position, do not move it unless necessary to protect the floor. If you have to, use a thick paper or cloth such as old carpet along the movement path.

---

## STEP 4 Adjust the levelling legs

---

### CAUTION

- The refrigerator must be levelled on a flat, solid floor. Failing to do so can cause damage to the refrigerator or physical injury.
- Levelling must be performed with an empty refrigerator. Make sure no food items remain inside the refrigerator.
- For safety reasons, adjust the front side a little higher than the rear side.

The refrigerator can be levelled using the front legs that have a special screw (leveller) for levelling purposes. Use a flat-head screwdriver for levelling.

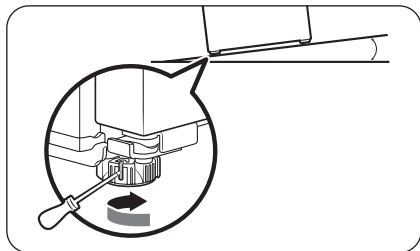

#### To adjust the height of the left side:

Insert a flat-head screwdriver into the leveller of the front left leg. Turn the leveller clockwise to raise, or turn it counter clockwise to lower.

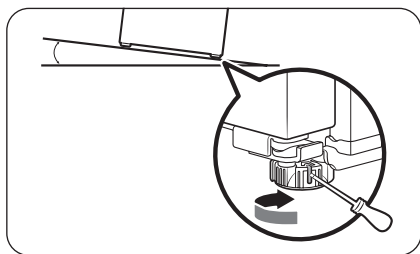

#### To adjust the height of the right side:

Insert a flat-head screwdriver into the leveller of the front right leg. Turn the leveller clockwise to raise, or turn it counter clockwise to lower.

# Installation

---

## STEP 5 Initial settings

---

By completing the following steps, the refrigerator should be fully functioning.

1. Remove the PE foam sheet on each shelf corner, which is attached to protect the refrigerator during transportation.
2. Plug the power cord into the wall socket to turn the refrigerator on .
3. Open the door, and check if the interior light lights up.
4. Set the temperature to the lowest, and wait until the refrigerator reaches the set temperature. Now the refrigerator is ready for use.

### NOTE

When the refrigerator powers on, the alarm will sound. To turn off the alarm, press Freezer.

## STEP 6 Final check

---

When installation is complete, confirm that:

- The refrigerator is plugged into an electrical outlet and grounded properly.
- The refrigerator is installed on a flat, level surface with a reasonable clearance from the wall or the cabinet.
- The refrigerator is level and is sitting firmly on the floor.
- The door opens and closes freely, and the interior light turns on automatically when you open the door.

# Operations

## Main panel

The actual appearance of your main panel may differ from the figure and the main panel design is subject to change without notice.

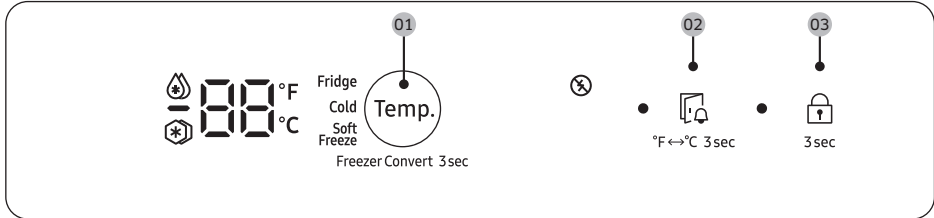

**01** Temp. / Freezer Convert 3 sec

**02** Door alarm



**03** Lock

\* Applicable models only

### 01 Temp. / Freezer Convert 3 sec

Temp.	<p>Tap <b>Temp.</b> to select the desired temperature or available function.</p> <ul style="list-style-type: none"> <li>The selection changes in the following cycle in the Freezer mode:  <math>0\text{ }^{\circ}\text{F} \rightarrow -1\text{ }^{\circ}\text{F} \rightarrow -2\text{ }^{\circ}\text{F} \rightarrow -3\text{ }^{\circ}\text{F} \rightarrow -4\text{ }^{\circ}\text{F} \rightarrow -5\text{ }^{\circ}\text{F} \rightarrow -6\text{ }^{\circ}\text{F} \rightarrow -7\text{ }^{\circ}\text{F} \rightarrow -8\text{ }^{\circ}\text{F}</math>  <math>\rightarrow</math> (Power Freeze) <math>\rightarrow 5\text{ }^{\circ}\text{F} \rightarrow 4\text{ }^{\circ}\text{F} \rightarrow 3\text{ }^{\circ}\text{F} \rightarrow 2\text{ }^{\circ}\text{F} \rightarrow 1\text{ }^{\circ}\text{F} \rightarrow 0\text{ }^{\circ}\text{F}</math>  <math>-19\text{ }^{\circ}\text{C} \rightarrow -20\text{ }^{\circ}\text{C} \rightarrow -21\text{ }^{\circ}\text{C} \rightarrow -22\text{ }^{\circ}\text{C} \rightarrow -23\text{ }^{\circ}\text{C} \rightarrow</math> (Power Freeze) <math>\rightarrow</math>  <math>-15\text{ }^{\circ}\text{C} \rightarrow -16\text{ }^{\circ}\text{C} \rightarrow -17\text{ }^{\circ}\text{C} \rightarrow -18\text{ }^{\circ}\text{C} \rightarrow -19\text{ }^{\circ}\text{C}</math></li> <li>The selection changes in the following cycle in the Fridge mode:  <math>37\text{ }^{\circ}\text{F} \rightarrow 36\text{ }^{\circ}\text{F} \rightarrow 35\text{ }^{\circ}\text{F} \rightarrow 34\text{ }^{\circ}\text{F} \rightarrow 44\text{ }^{\circ}\text{F} \rightarrow 43\text{ }^{\circ}\text{F} \rightarrow 42\text{ }^{\circ}\text{F} \rightarrow 41\text{ }^{\circ}\text{F}</math>  <math>40\text{ }^{\circ}\text{F} \rightarrow 39\text{ }^{\circ}\text{F} \rightarrow 38\text{ }^{\circ}\text{F} \rightarrow 37\text{ }^{\circ}\text{F} (3\text{ }^{\circ}\text{C} \rightarrow 2\text{ }^{\circ}\text{C} \rightarrow 1\text{ }^{\circ}\text{C} \rightarrow 7\text{ }^{\circ}\text{C} \rightarrow 6\text{ }^{\circ}\text{C} \rightarrow</math>  <math>5\text{ }^{\circ}\text{C} \rightarrow 4\text{ }^{\circ}\text{C} \rightarrow 3\text{ }^{\circ}\text{C} \rightarrow 2\text{ }^{\circ}\text{C})</math></li> <li>The temperature is fixed and cannot be changed in the Soft Freeze and Cold mode. <ul style="list-style-type: none"> <li>- Soft Freeze: <math>23\text{ }^{\circ}\text{F} (-5\text{ }^{\circ}\text{C})</math></li> <li>- Cold: <math>30\text{ }^{\circ}\text{F} (-1\text{ }^{\circ}\text{C})</math></li> </ul> </li> </ul>
-------	---

# Operations

<p>Freezer Convert 3 sec</p>	<p>Touch and hold <b>Temp.</b> for 3 seconds to select the desired operating mode.</p> <ul style="list-style-type: none"> <li>• The operating mode changes in the following cycle: Soft Freeze → Cold → Fridge</li> <li>• When the operating mode is Freezer, all the mode indicators (<b>Fridge</b>, <b>Cold</b>, and <b>Soft Freeze</b>) turn off.</li> <li>• <b>Fridge</b>, <b>Cold</b>, or <b>Soft Freeze</b> indicator turns on when the corresponding mode is selected.</li> </ul> <p> <b>CAUTION</b></p> <p>Before changing the operating mode, check that the food and containers stored inside are suitable for the selected mode to prevent damage or spoilage.</p>
<p>Power Freeze (applicable models only)</p>	<p>Power Freeze speeds up the freezing process at maximum fan speed. The freezer keeps running at full speed for 50 hours and then returns to the previous temperature.</p> <ul style="list-style-type: none"> <li>• To activate Power Freeze, press and hold <b>Temp.</b> for 3 seconds. The LED indicator on the left side of the button lights up, and the refrigerator will speed up the freezing process.</li> <li>• To deactivate, press and hold <b>Temp.</b> for 3 seconds again. The freezer returns to the previous temperature setting.</li> <li>• To freeze large amounts of food, activate Power Freeze for at least 20 hours before putting food in the freezer.</li> </ul> <p> <b>NOTE</b></p> <ul style="list-style-type: none"> <li>• Using Power Freeze increases power consumption. Make sure you turn it off and return to the previous temperature if you do not intend to use it.</li> <li>• To quickly freeze large quantities of food, remove the drawers and use the provided shelf.</li> <li>• Power Freeze can only be activated when the refrigerator is in the Freezer mode.</li> </ul>

## **WARNING**



- Do not put glass bottles containing liquid in the freezer. When cancelling Fridge mode, the glass bottles may break or burst in the freezer.
- Make sure to remove frozen food from the freezer before enabling the Fridge mode. Frozen foods melt and spoil as the temperature increases (Freezer mode changes to Fridge mode).
- Make sure to remove chilled foods from the freezer before disabling the Freezer mode. Chilled foods may freeze as the temperature decreases (Fridge mode changes to Freezer mode).

---

**NOTE**

If you want to use Fridge mode, it is strongly recommended to use plastic containers to store food, especially vegetables.

## 02 Door Alarm / °F ↔ °C 3 sec

Door Alarm	Tap the  button to turn the door alarm on or off. <ul style="list-style-type: none"><li>• If the door is left open for more than 2 minutes, the alarm will sound, and the LED indicator on the left side of the button will blink.</li><li>• If the door is left open for 5 minutes, internal light (in the fridge, freezer) will blink for 5 minutes and turn off. This is for alerting the hearing-impaired person, and it is normal.</li></ul>
°F ↔ °C 3 sec	Touch and hold the  button for 3 seconds to switch the temperature unit between Celsius and Fahrenheit.



## 03 Lock (3 sec)

Touch and hold the  button for 3 seconds to turn the Lock function on or off.

- When you turn on the function, all controls will be disabled, and the LED indicator on the left side of the button will turn on.
- After you turn on the function, you must turn it off to use the main panel again.

## Activating or deactivating the Sabbath mode

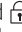
The Sabbath mode stays active for 85 hours once it is activated. After that, it will be deactivated automatically.

- To activate and deactivate the Sabbath mode, touch and hold the  and  buttons simultaneously for 6 seconds. Then, when the display blinks, tap the  button.

**NOTE**

The Sabbath mode stays active even if the refrigerator powers off. To exit the Sabbath mode, you must deactivate it manually.

# Operations

---

## Special features

---

The actual image and special functions of your refrigerator may differ depending on the model and the country.

### Ice making (applicable models only)

#### Twist ice maker (applicable models only)

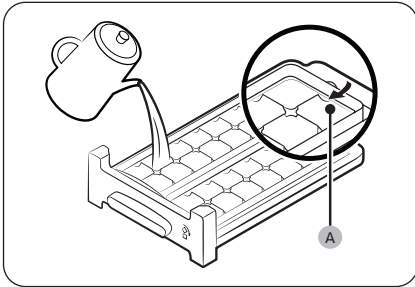

1. Open the freezer door, and slide open the ice tray.
2. Fill the tray with water up to the **maximum level (A)** marked on the inner rear of the tray.
3. Slide the tray back into position.

 **NOTE**

The ice making time depends on your temperature settings.

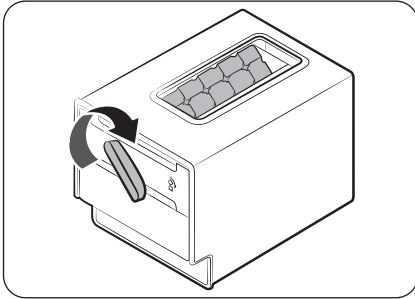

 **NOTE**

- Make sure the ice cube storage bin is in place under the ice tray.
- To dispense the ice cubes, turn the ice tray handle to the right to empty the ice cubes into the bin.
- To take out the bin, pull it forward.
- Put the twist ice maker on the freezer shelf if it does not fit under the shelf.

---

Tray type (applicable models only)

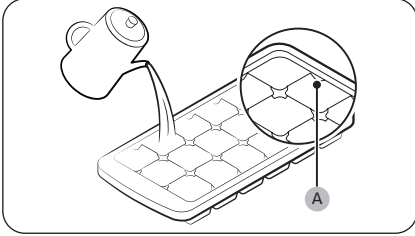

To make ice cubes, fill the tray with water up to the **maximum level (A)** marked on the inner rear of the tray.

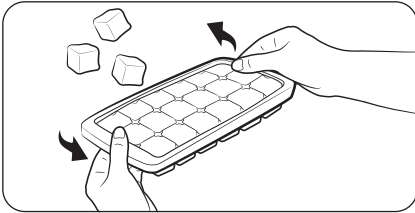

To empty the ice tray, hold both ends of the tray and gently twist to remove the ice cubes.

# Operations

---

## To secure more storage space (applicable models only)

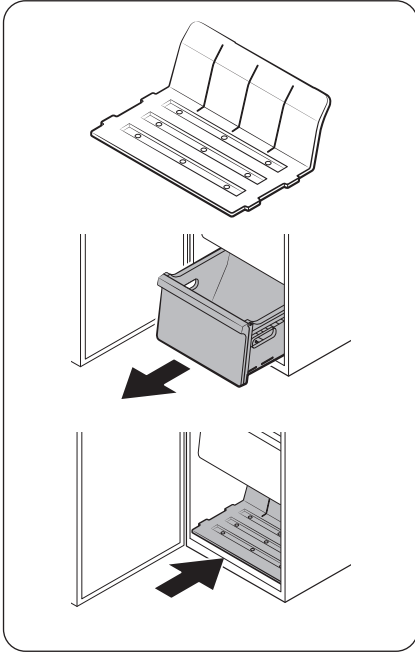

If you need more storage space, remove the top shelf cover and all 4 drawers and insert the provided shelf (see the figure) in the inner bottom of the main unit. Then, remove the Slim Ice Maker.

### NOTE

- Removal of the top shelf cover and the drawers does not affect thermal and mechanical characteristics of the freezer.
- A declared storage volume of the freezer is based on the conditions where the top shelf cover and all the drawers are removed and the provided shelf is inserted.

# Maintenance

---

## Door reversal

---

### **WARNING**

- The warranty does not cover reversal failure or property damage occurring due to unapproved agencies.
- Make sure that the refrigerator is disconnected from the power source before reversing the door.
- You must wait for at least an hour after door reversal is complete. This is to prevent any electric shock that could occur.
- Reversing the door must be performed by Samsung-approved servicing personnel at your own expense because this kind of servicing is not covered by the Warranty.

### **CAUTION**

The door is heavy. Have at least two people work on the door reversal. Otherwise, it may cause a personal injury.

### Tools required (not provided)



Phillips screwdriver



Flat-head  
screwdriver



Adjustable wrench

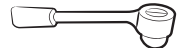

8 mm socket  
wrench  
(for bolts)

### Accessories

The accessories below may differ in appearance depending on the model.



Top-left door hinge cover

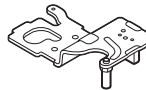

Top-left door hinge



Cam riser



Low cam riser

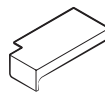

Cap space

# Maintenance

## CAUTION

Throughout the entire reversal procedure, keep all the small parts (screws, caps, etc.) of the refrigerator away from children or infants for safety reasons.

### Step-by-step instructions

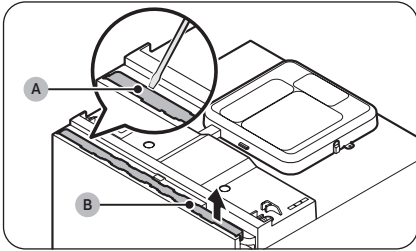

1. Use the flat-head screwdriver to unlock the hook (A) of the wire cover (B), located on the top of the door) before pulling up to remove.

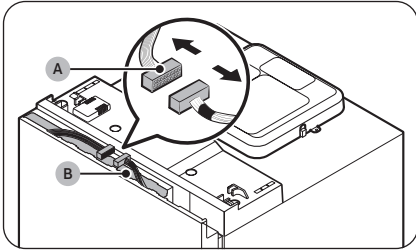

2. Remove and disconnect the wire connector (A) from inside the cap door (B), which is located on the top of the door. (applicable models only)

## CAUTION

Keep the wire cover (B, in the above step) in a safe place for later use.

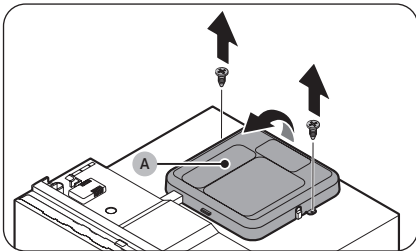

3. Use the Phillips screwdriver to loosen the left/right screws (x2) from the PBA cover (A), which is on the top of the refrigerator. Pull up the rear of the PBA cover (A) first to remove.

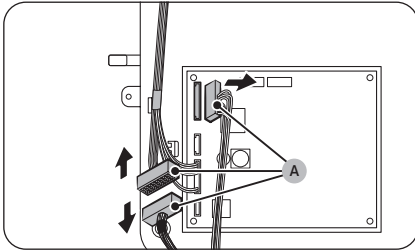

4. Remove the top cable wires (A) from inside the PBA box.

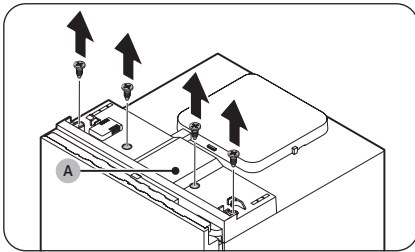

5. Use the Phillips screwdriver to loosen the screws (x4) from the top table. Pull up gently to release the hook of the hinge cover (A) before removing the top table from the refrigerator.

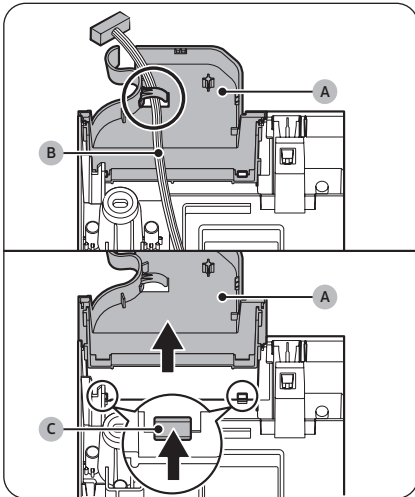

6. Remove the wires (B) from the hinge cover (A) of the top table. Then, press to release the hooks (x2, C) simultaneously and pull up the hinge cover (A).

### CAUTION

Keep the hinge cover (A) in a safe place for reversing the door later.

# Maintenance

---

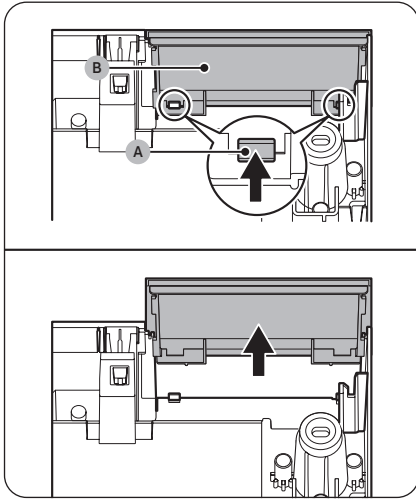

7. From the opposite side, press to release the hooks (x2, A) simultaneously and pull up the hinge cap (B).

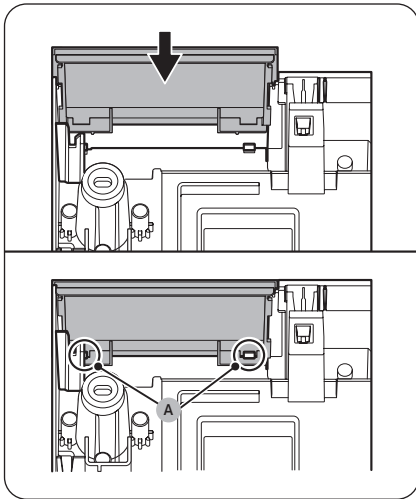

8. Insert the hinge cap (B, in Step 7) in the position of the hinge cover (A, in Step 6) until the hooks (A) are properly locked.

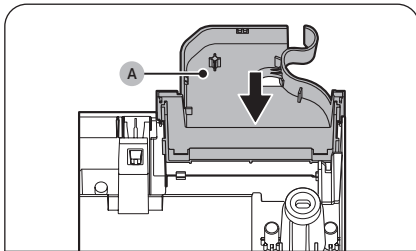

9. Press to fit the hinge cover (A) of the top right door in the position of the hinge cap (B, in Step 7).

**NOTE**

Use the hinge cover (A) of the top-right door included in the door reversing kit.

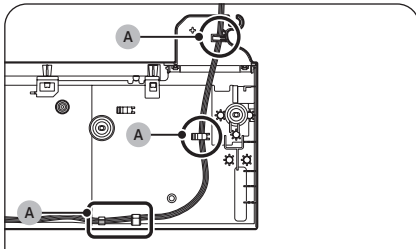
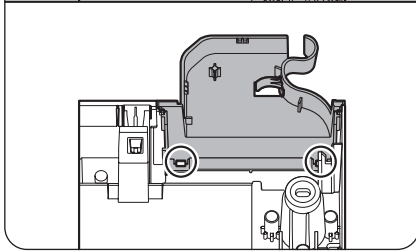

10. Reinsert the wires (B, in Step 6) and insert the wire tapes in the cable holders (A) of the hinge cover (A, in Step 9).

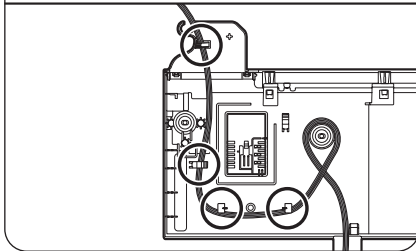

# Maintenance

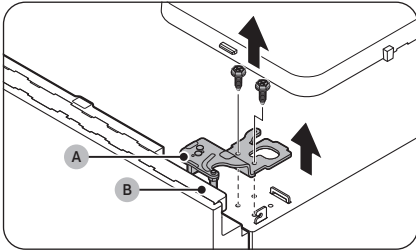

11. Use the 8 mm wrench to loosen the screws (x2) from the **top hinge (A)**. Lift the **top hinge (A)** gently so that the shaft is detached from the **cap door (B)**.

## ⚠ CAUTION

- Take caution not to drop the door. Otherwise, the door can cause a physical injury due to its weight.
- Keep the **top hinge (A)** in a safe place for reversing the door later.

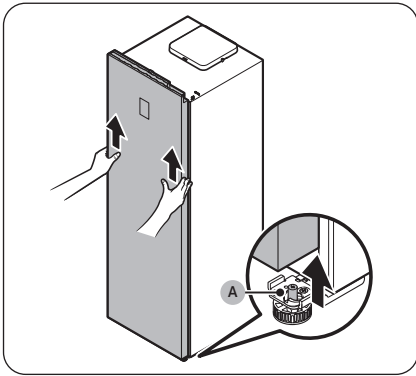

12. Lift the door so that it is detached from the shaft of the **low hinge (A)**.

## ⚠ CAUTION

Take caution not to drop the door. Otherwise, the door can cause a physical injury due to its weight.

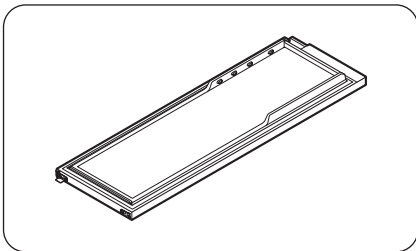

13. Lay down the door on the floor.

## 📦 NOTE

Put a carton box on the floor to prevent damage to the door.

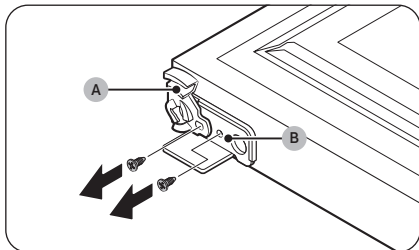

- 14.** Use the Phillips screwdriver to loosen the screws at the bottom of the door. Then, remove the cam riser (A) and the stopper (B).

**! CAUTION**

Keep the cam riser (A) in a safe place for reversing the door later.

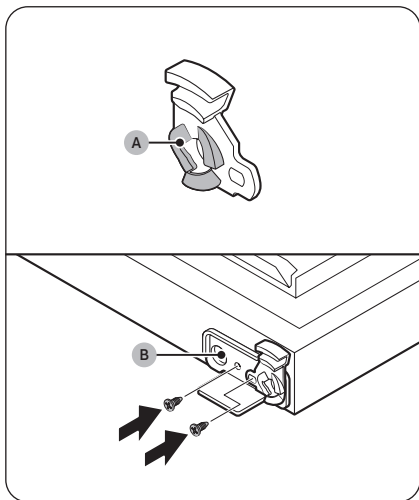

- 15.** Apply grease (not provided) to the cam riser (A) in the shading areas as shown. Then, insert the stopper (B) and the cam riser (A) in this sequence in the opposite of the door bottom. Use the Phillips screwdriver to tighten the screws.

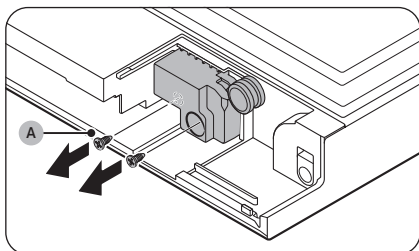

- 16.** Use the Phillips screwdriver to loosen the auto close screws (x2, A) at the top of the door.

# Maintenance

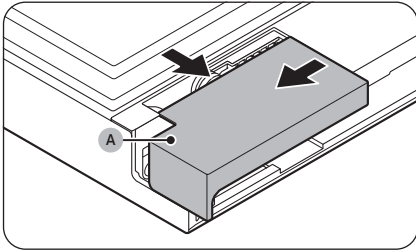

17. Pull upward then outward the **cap space (A)** at the top of the door (the opposite side of the **auto close**) to remove.

## CAUTION

Keep the **cap space (A)** in a safe place for reversing the door later.

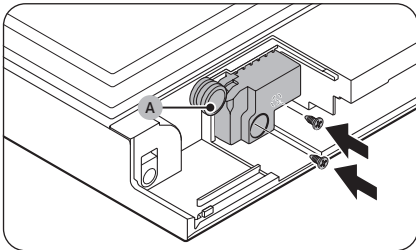

18. Insert the **auto close (A)** in the **cap space (A)**, in Step 17) position. Then, use the Phillips screwdriver to tighten the screws (x2).

## NOTE

You can use the **auto close (A)** in the reverse direction as well.

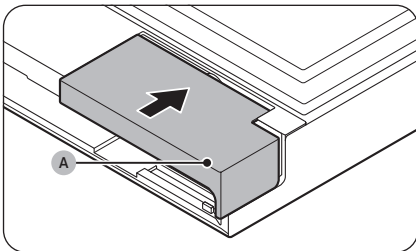

19. Slide in the provided **cap space (A)** along the **door cap rib**, (where the **auto close** was removed) until the protruding part of the **cap space (A)** inserts into the **door cap hole**.

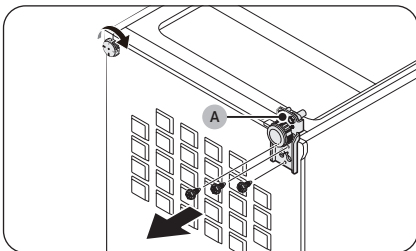

20. Lay down the refrigerator on the floor.  
21. Use the Phillips screwdriver to loosen the screws (x3) of the **low hinge (A)** at the bottom of the refrigerator. Turn to remove the leveling leg, which is in the opposite side of the **low hinge (A)**.

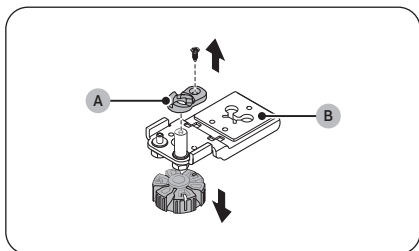

22. Use the Phillips screwdriver to loosen the screws of the **low cam riser (A)**. Then, remove the leveling leg from the **low hinge (B)**.

### ⚠ CAUTION

Keep the **low cam riser (A)** in a safe place for reversing the door later.

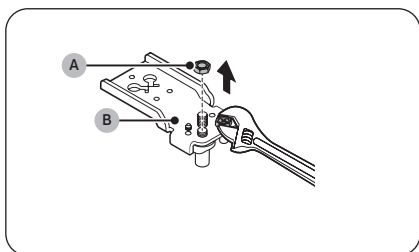

23. Use the 12 mm socket wrench to loosen the **shaft nuts (x2, A)** on the **low hinge (B)**.

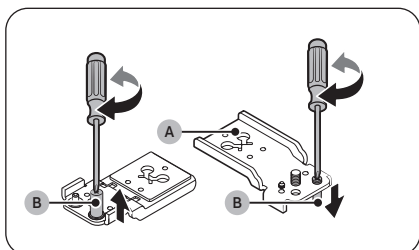

24. Use the Phillips screwdriver to remove the two **shafts (B)** from the **low hinge (A)** and switch their positions before reinserting. Tighten the **shaft nut (x2, A)** in Step 23) in each **shaft (x2, B)**. Then, reinsert the leveling leg.

### ⚠ CAUTION

Make sure to switch the position of each shaft before reinserting.

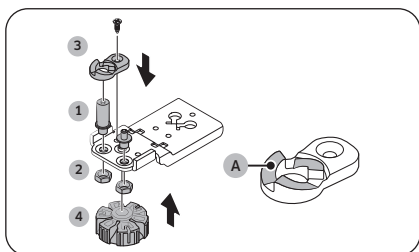

25. Apply grease (not provided) to the shading areas of the **low cam riser (A)** as shown. Insert the **low cam riser (A)** in the shaft position before tightening with the screw.

# Maintenance

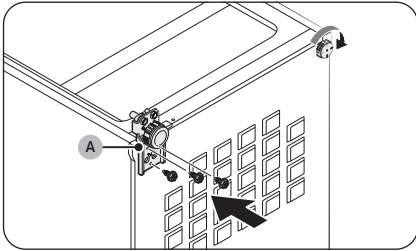

26. Use the Phillips screwdriver to tighten the **low hinge (A)** with the screws (x3) in the opposite side of the refrigerator's bottom.

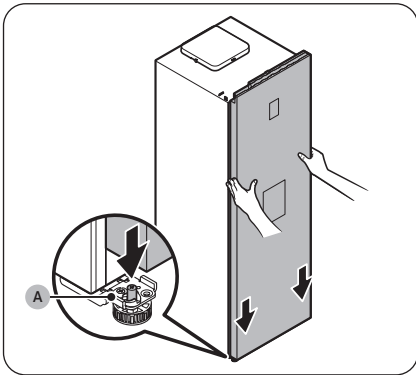

27. Set the refrigerator upright.  
28. Reinsert the door so that it fits into the shaft of the **low hinge (A)**.

## CAUTION

Take caution not to drop the door. Otherwise, the door can cause a physical damage due to its weight.

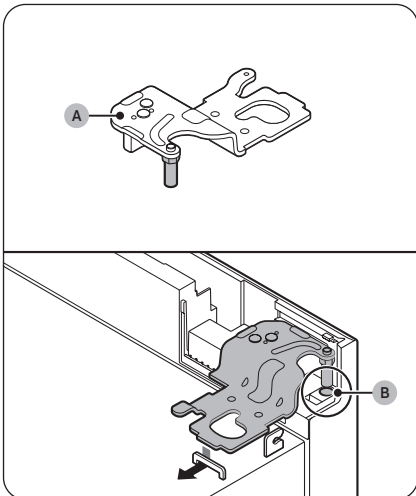

29. Apply grease (not provided) to the rear shaft of the provided **top-left door hinge (A)**. Hook the shaft to the rear locking position before turning it slowly until it inserts into the **door hole (B)**.

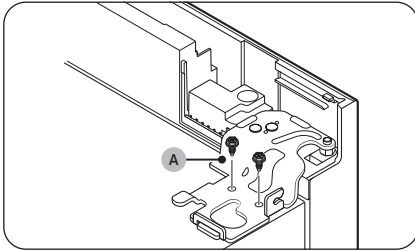

30. Use the Phillips screwdriver or the 8 mm socket wrench to tighten the **top hinge (A)** using the screws (x2).

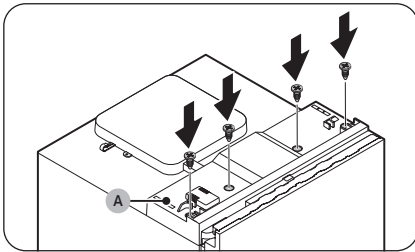

31. Hook the **hinge cover (A)** to the hinge before tightening it on the top table using the screws (x4).

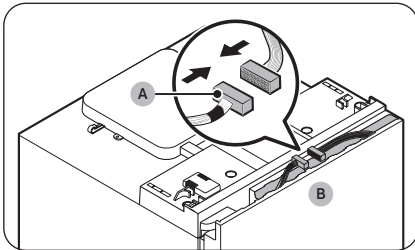

32. Reconnect the **wire connectors (A)** inside the **cap door (B)** before arranging the wires inside the cap door (B). (applicable models only)

**! CAUTION**

Make sure the wires are not exposed outside.

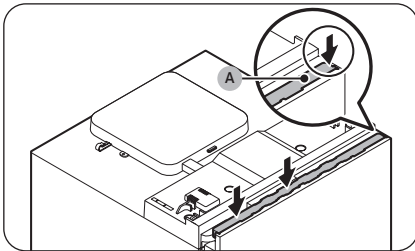

33. Insert the **wire cover (A)** with the opposite side of the hinge first.

**! CAUTION**

Make sure the wires are not exposed outside.

# Maintenance

---

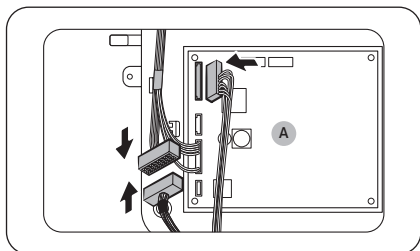

- 34.** Connect the wires inside the **PBA box (A)**, located on the top of the refrigerator) to the PBA.

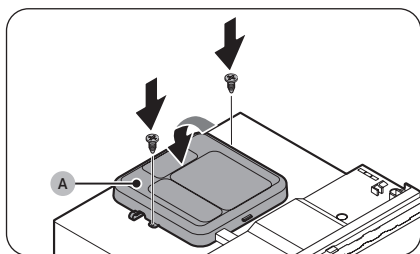

- 35.** Hook the front side of the **PBA cover (A)** to the PBA box. Then, press down to fix the **PBA cover (A)**.
- 36.** Use the Phillips screwdriver to fasten the **PBA cover (A)** using the screws (x2).

## Auto Open Door option touch sensor reversible (applicable models only)

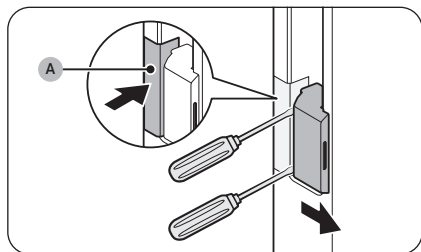

1. Put the **protective tape (A)** on the rear of the Auto Open Door sensor (located on the recess handle of the door). Then, insert the flat-head screwdriver (3-6 mm head) in the hook of the Auto Open Door sensor to remove.

### CAUTION

To prevent scratches on the Auto Open Door sensor, make sure to put the **protective tape (A)** on the sensor.

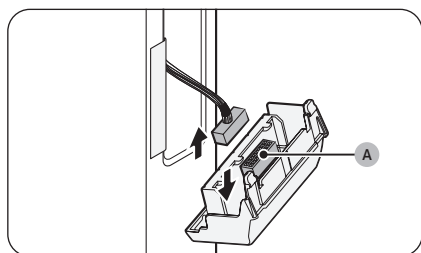

2. Disconnect the **wire connector (A)** of the touch sensor.

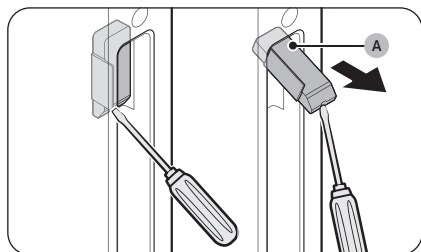

3. Insert the flat-head screwdriver in the **handle cover (A)**, located in the opposite of the touch sensor) to remove.

# Maintenance

---

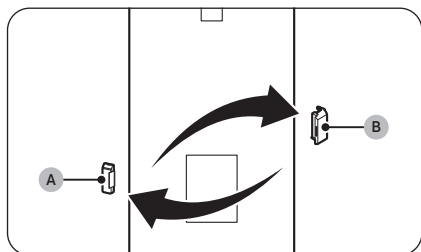

4. Switch the positions of the **touch sensor (A)** and the **handle cover (B)** before reinserting them.

 **NOTE**

Before reinserting the touch sensor, be sure to reconnect the **wire connector (A)**, in Step 2).

## Reversing the door handle position (applicable models only)

---

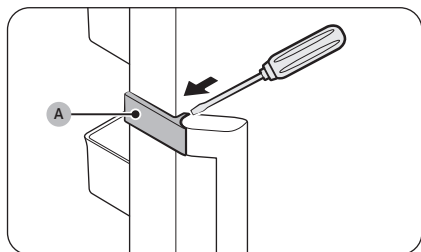

1. Remove the **handle cover (A)**.

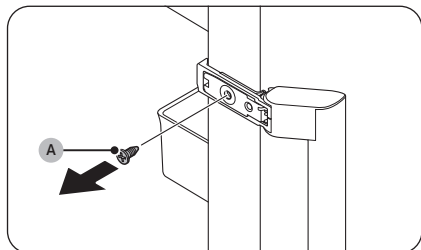

2. Use a Phillips screwdriver to remove the **screw (A)** and detach the handle.

 **CAUTION**

Keep the handle in a safe place for later use.

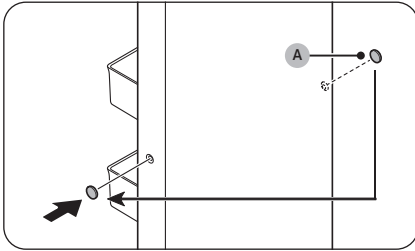

3. Use a flat-head screwdriver to remove the **hole cap (A)** from the opposite side of the door.

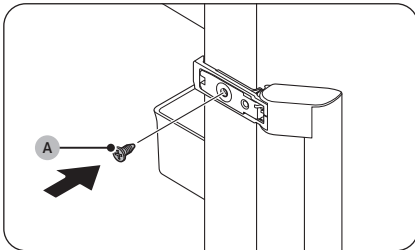

4. Insert the **hole cap (A, in the above step)** into the hole from which you detached the handle.
5. Place the handle on the opposite side of the door, aligning the holes on the handle and the door.
6. Use a Phillips screwdriver to attach the handle with the **screw (A)**.

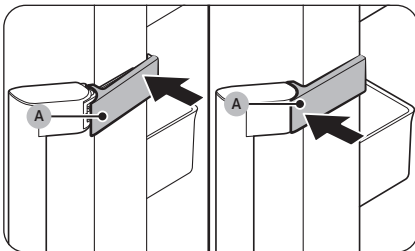

7. Attach the **handle cover (A)**.

# Maintenance

---

## Handle and care

---

### Shelves

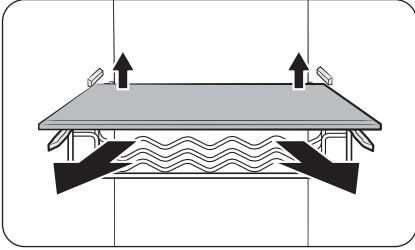

Slightly lift up the rear side of the shelf to pull out.

### Door guards

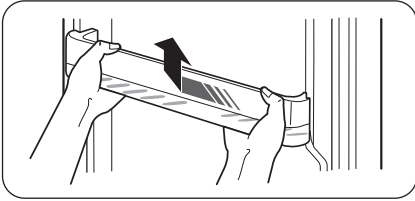

Slightly lift up and pull out the door guard.

### CAUTION

To prevent accidents, empty the door guards before removing.

### Top shelf cover

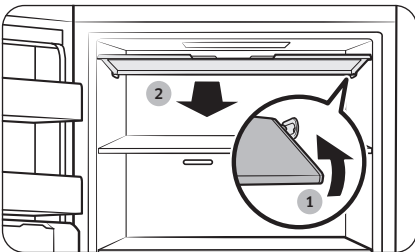

1. Push the right side of the cover inwards to unhook the cover.
2. Then, pull up the cover to the front to remove.

---

## Cleaning

---

### Interior and exterior

#### **WARNING**

- Do not use benzene, thinner, vinegar, liquid bleach, baking soda, citric, salt mixtures or home/car detergent such as Clorox™ for cleaning purposes. They may damage the surface of the refrigerator and cause a fire.
- Do not spray water onto the refrigerator. This may cause electric shock.

Regularly use a dry cloth to remove all foreign substances such as dust or water from the power plug terminals and contact points.

1. Unplug the power cord.
2. Use a moistened, soft, lint-free cloth or paper towel to clean the refrigerator's interior and exterior.
3. When done, use a dry cloth or paper towel to dry well.
4. Plug in the power cord.

## Replacement

---

### LED Lamps

To replace the lamps of the refrigerator, contact a local Samsung service centre.

#### **WARNING**

- The lamps are not user-serviceable. Do not attempt to replace a lamp yourself. This can cause electric shock.

# Troubleshooting

Before calling for service, review the symptoms and recommended solutions below. If none of the suggested solutions resolve your problem, please visit our website at [www.samsung.com](http://www.samsung.com) or call Samsung Customer Care at 1-800-SAMSUNG (726-7864). Note that you will be charged for any service visits in which no defects were found.

## General

### Temperature

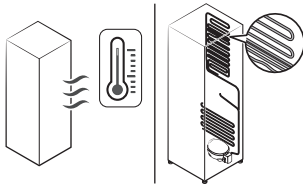
Symptom	Possible causes	Solution
Freezer does not operate. Freezer temperature is warm.	<ul style="list-style-type: none"> <li>Power cord is not plugged in properly.</li> </ul>	<ul style="list-style-type: none"> <li>Properly plug in the power cord.</li> </ul>
	<ul style="list-style-type: none"> <li>Temperature control is not set correctly.</li> </ul>	<ul style="list-style-type: none"> <li>Set the temperature lower.</li> </ul>
	<ul style="list-style-type: none"> <li>Refrigerator is located near a heat source or direct sunlight.</li> </ul>	<ul style="list-style-type: none"> <li>Keep the refrigerator away from direct sunlight or a heat source.</li> </ul>
	<ul style="list-style-type: none"> <li>Not enough clearance between refrigerator and sides/rear.</li> </ul>	<ul style="list-style-type: none"> <li>We recommend that the gap between the refrigerator and nearby walls (or cabinets) is more than 2" (50 mm).</li> </ul>
	<ul style="list-style-type: none"> <li>The refrigerator is overloaded. Food is blocking the refrigerator vents.</li> </ul>	<ul style="list-style-type: none"> <li>Do not overload the refrigerator. Do not allow food to block ventilation.</li> </ul>
Freezer is over-cooling.	<ul style="list-style-type: none"> <li>Temperature control is not set correctly.</li> </ul>	<ul style="list-style-type: none"> <li>Set the temperature higher.</li> </ul>
Interior wall is hot.	<ul style="list-style-type: none"> <li>Refrigerator has heat-proof piping in the interior wall.</li> </ul>	<ul style="list-style-type: none"> <li>To prevent condensation from forming, the refrigerator has heat-proof piping in the front corners. If the ambient temperature rises, this equipment may not work effectively. This is not a system failure.</li> </ul> 

---

## Odors

Symptom	Possible causes	Solution
Refrigerator has odors.	• Spoiled food.	• Clean the refrigerator and remove any spoiled food.
	• Food with strong odors.	• Make sure strong smelling food is wrapped airtight.

## Condensation

Symptom	Possible causes	Solution
Condensation forms on the interior walls.	• If door is left open, moisture enters the refrigerator.	• Remove the moisture and do not open the door for a long time.
	• Food with high moisture content.	• Make sure food is wrapped airtight.

# Troubleshooting

## Do you hear abnormal sounds from the refrigerator?

Before calling for service, review the information below. If you still have questions about sounds your refrigerator is making, please call Samsung Customer Care at 1-800-SAMSUNG (726-7864). Note that you will be charged for any service visits related to normal operating sounds in which no defects were found.

### These sounds are normal.

- When starting or ending an operation, the refrigerator may make sounds similar to a car engine igniting. As the operation stabilizes, the sounds will decrease.

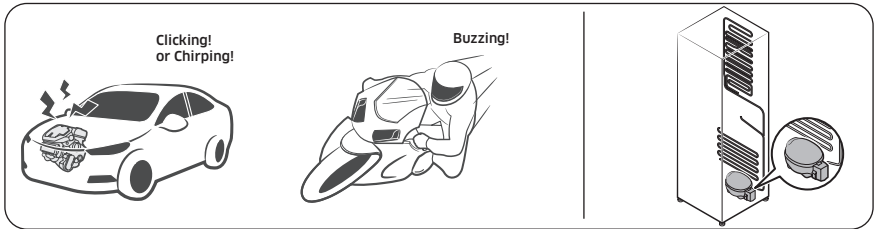

- While the fan is operating, these sounds may occur. When the refrigerator reaches the set temperature, no fan sound will occur.

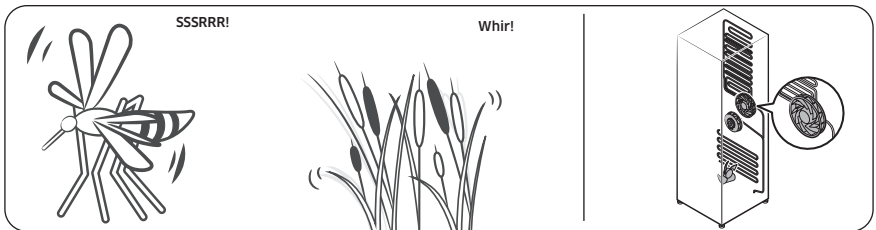

- During a defrost cycle, water may drip on the defrost heater, causing sizzling sounds.

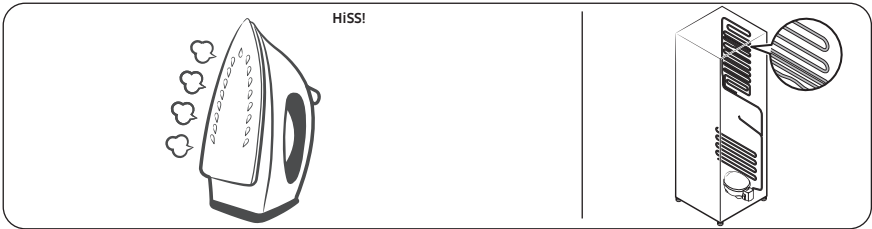

- As the refrigerator cools or freezes, refrigerant gas moves through sealed pipes, causing bubbling sounds.

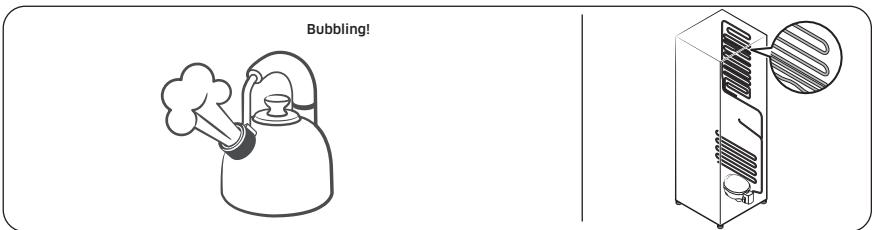

- As the refrigerator temperature increases or decreases, plastic parts contract and expand, creating knocking noises. These noises occur during the defrosting cycle or when electronic parts are working.

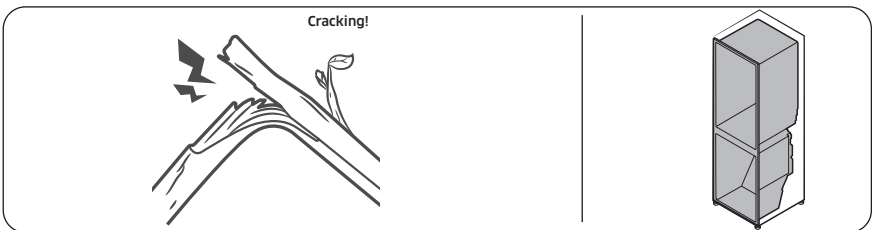

- For ice maker models: When the water valve opens to fill the ice maker, buzzing sounds may occur.
- Due to pressure equalizing when opening and closing the refrigerator door, whooshing sounds may occur.

# LIMITED WARRANTY (U.S.A.)

---

## SAMSUNG REFRIGERATOR

---

### LIMITED WARRANTY TO ORIGINAL CONSUMER PURCHASER WITH PROOF OF PURCHASE

This SAMSUNG brand product, as supplied and distributed by Samsung Electronics America, Inc. (SAMSUNG) and delivered new, in the original carton to the original consumer purchaser, is warranted by SAMSUNG against manufacturing defects in materials or workmanship for the limited warranty periods, starting on the date of delivery to the original consumer purchaser:

**One (1) year parts and labor**

**Five (5) years parts and labor on Sealed Refrigeration System Only (Compressor, Evaporator, Condenser, Drier, and Connecting Tubing)**

**Ten (10) years part and Five (5) years labor on Digital Inverter Compressor Only**

This limited warranty is valid only on products purchased and used in the United States that have been installed, operated, and maintained according to the instructions attached to or furnished with the product. To receive warranty service, the purchaser must contact SAMSUNG at the address or phone number provided below for problem determination and service procedures. Warranty service can only be performed by a SAMSUNG authorized service center. The original dated bill of sale and/or proof of delivery must be presented upon request as proof of purchase to SAMSUNG or SAMSUNG's authorized service center to receive warranty service.

SAMSUNG will provide in-home service within the contiguous United States during the warranty period at no charge, subject to availability of SAMSUNG authorized servicers within the customer's geographic area. If in-home service is not available, SAMSUNG may elect, at its option, to provide transportation of the product to and from an authorized service center. If the product is located in an area where service by a SAMSUNG authorized servicer is not available, you may be responsible for a trip charge or required to bring the product to a SAMSUNG authorized service center for service.

To receive in-home service, product must be unobstructed and accessible to the service agent.

During the applicable warranty period, a product will be repaired, replaced, or the purchase price refunded, at the sole option of SAMSUNG. SAMSUNG may use new or reconditioned parts in repairing a product, or replace the product with a new or reconditioned product. Replacement parts and products are warranted for the remaining portion of the original product's warranty or ninety (90) days, whichever is longer. All replaced parts and products are the property of SAMSUNG and you must return them to SAMSUNG.

---

This limited warranty covers manufacturing defects in materials or workmanship encountered in normal household, noncommercial use of this product and shall not cover the following: damage that occurs in shipment, delivery, installation, and uses for which this product was not intended; damage caused by unauthorized modification or alteration of the product; product where the original factory serial numbers have been removed, defaced, changed in any way, or cannot be readily determined; cosmetic damage including scratches, dents, chips, and other damage to the product's finishes; damage caused by abuse, misuse, pest infestations, accident, fire, floods, or other acts of nature or God; damage caused by use of equipment, utilities, services, parts, supplies, accessories, applications, installations, repairs, external wiring or connectors not supplied or authorized by SAMSUNG; damage caused by incorrect electrical line current, voltage, fluctuations and surges; damage caused by failure to operate and maintain the product according to instructions; in-home instruction on how to use your product; and service to correct installation not in accordance with electrical or plumbing codes or correction of household electrical or plumbing (i.e., house wiring, fuses, or water inlet hoses). The cost of repair or replacement under these excluded circumstances shall be the customer's responsibility.

Visits by an authorized servicer to explain product functions, maintenance or installation are not covered by this limited warranty. Please contact SAMSUNG at the number below for assistance with any of these issues.

## **EXCLUSION OF IMPLIED WARRANTIES**

IMPLIED WARRANTIES, INCLUDING THE IMPLIED WARRANTIES OF MERCHANTABILITY OR FITNESS FOR A PARTICULAR PURPOSE, ARE LIMITED TO ONE YEAR OR THE SHORTEST PERIOD ALLOWED BY LAW. Some states do not allow limitations on how long an implied warranty lasts, so the above limitations or exclusions may not apply to you. This warranty gives you specific rights, and you may also have other rights, which vary from state to state.

# LIMITED WARRANTY (U.S.A.)

---

## LIMITATION OF REMEDIES

YOUR SOLE AND EXCLUSIVE REMEDY IS PRODUCT REPAIR, PRODUCT REPLACEMENT, OR REFUND OF THE PURCHASE PRICE AT SAMSUNG'S OPTION, AS PROVIDED IN THIS LIMITED WARRANTY. SAMSUNG SHALL NOT BE LIABLE FOR SPECIAL, INCIDENTAL OR CONSEQUENTIAL DAMAGES, INCLUDING BUT NOT LIMITED TO TIME AWAY FROM WORK, HOTELS AND/OR RESTAURANT MEALS, REMODELING EXPENSES, LOSS OF REVENUE OR PROFITS, FAILURE TO REALIZE SAVINGS OR OTHER BENEFITS REGARDLESS OF THE LEGAL THEORY ON WHICH THE CLAIM IS BASED, AND EVEN IF SAMSUNG HAS BEEN ADVISED OF THE POSSIBILITY OF SUCH DAMAGES. Some states do not allow exclusion or limitation of incidental or consequential damages, so the above limitations or exclusions may not apply to you. This warranty gives you specific rights, and you may also have other rights, which vary from state to state.

SAMSUNG does not warrant uninterrupted or error-free operation of the product. No warranty or guarantee given by any other person, firm, or corporation with respect to this product shall be binding on SAMSUNG.

To obtain warranty service, please contact SAMSUNG at:

Samsung Electronics America, Inc.  
700 Sylvan Avenue,  
Englewood Cliffs, NJ 07632  
1-800-SAMSUNG (726-7864)  
[www.samsung.com/support](http://www.samsung.com/support)

# Warranty Information (CANADA)

---

## If your refrigerator needs service

---

Do not hesitate to call any Samsung Authorized Service Center nearby giving them your name, address and telephone number if your product is not functioning properly.

## Limited Warranty for Original Purchaser

---

This Samsung product is warranted by Samsung Electronics Canada Inc. (hereafter referred to as SECA) against manufacturing defects in material or workmanship for the following periods:

Labor: 1 year (in-home)

Parts: 1 year

Inverter Compressor: 10 years (Part only)

SECA further warrants that if this product fails to operate properly within the specified warranty period and the failure is due to improper workmanship or defective material, SECA will repair or replace the product at its option. In-home service is not available in all areas. Contact us to find out if in-home service is currently available in your area by using the contact information at the back of this warranty.

All warranty repairs or part replacements must be performed by a SECA Authorized Service Center. (To find the nearest SECA Service Center, call 1-800-SAMSUNG (7267864) or visit our web site at [www.samsung.com/ca](http://www.samsung.com/ca))

## Obligation to the Original Owner

---

The original dated sales receipt must be retained by the customer and is the only acceptable proof of purchase. It must be presented to a SECA Authorized Service Center at the time service is requested before warranty services are rendered. On all carry-in models, transportation to and from the Authorized Service Center is the responsibility of the customer.

# Warranty Information (CANADA)

---

## Exclusions of the Warranty

---

This warranty does not cover damage due to accident, fire, flood, and/or other Acts of God, misuse, incorrect line voltage, improper installation, improper or unauthorized repairs, commercial use, or damage that occurs during shipping. Customer adjustments which are explained in this owners manual are not covered under the terms of this warranty. This warranty will automatically be voided for any unit found with a missing or altered serial number. This warranty is valid only on products purchased and used in Canada.

### SAMSUNG CUSTOMER CARE CENTER

Samsung Electronics Canada Inc.  
2050 Derry Road West  
Mississauga, Ontario L5N 0B9  
Canada  
1-800-Samsung (726-7864)  
[www.samsung.com/support](http://www.samsung.com/support)

## NOTICE TO QUEBEC CONSUMERS – Warranty of Availability of Replacement Parts, Repair Services, and Maintenance and Repair Information

---

### Replacement Parts

Although Samsung Canada will use reasonable efforts to make replacement parts available to customers (subject to availability and applicable lead times), Samsung Canada **does not guarantee** the availability of replacement parts within the meaning of the warranty of availability set out in sections 39 (paragraph 3), 39.1 and 39.2 of the Quebec Consumer Protection Act.

To purchase replacement parts and tools for self-repair, please visit:  
[samsung.com/ca/support/buy-certified-parts](http://samsung.com/ca/support/buy-certified-parts)

### Repair Services

Although Samsung Canada offers repair services for Samsung products through Samsung Authorized Service Centers located in most major urban centers (defined as a city in Canada with a population equal or greater than 50,000) across Canada, Samsung Canada **does not guarantee** the availability of any repair services within the meaning of the warranty of availability set out in sections 39 (paragraph 3), 39.1 and 39.2 of the Quebec Consumer Protection Act in all locations, cities, or regions in Quebec.

To find your nearest Samsung Authorized Service Center, please visit:  
[samsung.com/ca/support/service-center](http://samsung.com/ca/support/service-center)

---

## Information for Maintenance or Repair

Although Samsung Canada provides information on the maintenance and/or repair of goods for select Samsung products (please visit [samsung.com/ca/support/self-repair](http://samsung.com/ca/support/self-repair) for more information), Samsung Canada **does not guarantee** the availability of information that is necessary to maintain or repair Samsung products within the meaning of the warranty of availability set out in sections 39 (paragraph 3), 39.1 and 39.2 of the Quebec Consumer Protection.

---

## DISCLAIMER OF LIABILITY

Samsung is not liable for any damage or defect determined to be caused by repair by a non-authorized service provider, self-repair or non-professional repair of the product. Samsung is not liable for any resulting damage to the product, person, or property, or any injury or other product safety issue caused by or resulting from any repair, or any attempt to repair, any diagnosis, maintenance, or modification performed by any person, including, but not limited to, any of the following: (i) any indirect, incidental, special, or consequential damages (including but not limited to, damage to or loss of personal or commercial property, damage to reputation, loss of use, cost of purchase of replacement goods, etc.); (ii) any loss of data, goodwill, privacy, or profits or loss of business opportunity; and (iii) any inability to use, or reduced functionality of, the product. Any damage or defect to product resulting from a repair, or an attempt to repair, the product by any person (other than a Samsung certified service provider) will not be covered by the warranty. Samsung's liability shall be limited to the greatest extent permitted by law.

All text, graphics, user interfaces, visual interfaces, photographs, trademarks, and logos (collectively, "Content"), including but not limited to the design, structure, selection, coordination, "look and feel" and arrangement of such Content, contained in this manual is owned, controlled or licensed by or to Samsung, and is protected by trade dress, copyright, patent and trademark laws, and various other intellectual property rights and unfair competition laws.

No part of this manual or the Content may be copied, reproduced, republished, uploaded, posted, publicly displayed, encoded, translated, transmitted or distributed in any way (including "mirroring") to anyone, any entity, any other computer, server, Web site or other medium for publication or distribution or for any commercial purpose, without Samsung's express prior written consent.

# Warranty Information (CANADA)

---

Limitation of Liability. WHILE SAMSUNG MAKES ALL REASONABLE EFFORTS TO ENSURE THAT ALL INFORMATION IN THIS MANUAL IS CORRECT, SAMSUNG DOES NOT ASSUME ANY RESPONSIBILITY FOR THE ACCURACY OR COMPLETENESS OF ANY INFORMATION CONTAINED IN THIS MANUAL. SAMSUNG PROVIDES INFORMATION AND MATERIALS CONTAINED IN THIS MANUAL TO YOU ON AN "AS IS" BASIS WITHOUT WARRANTY OF ANY KIND, EITHER EXPRESS OR IMPLIED. SAMSUNG SPECIFICALLY DISCLAIMS ANY LIABILITY FOR ANY DIRECT, INDIRECT, INCIDENTAL, CONSEQUENTIAL OR SPECIAL DAMAGES ARISING OUT OF OR IN ANY WAY CONNECTED WITH YOUR ACCESS TO OR USE OF THE INFORMATION IN THIS MANUAL, INCLUDING BUT NOT LIMITED TO ANY LOSS OR DAMAGE CAUSED BY YOUR RELIANCE ON INFORMATION OBTAINED THROUGH THIS MANUAL. Some jurisdictions do not allow exclusion of certain warranties or limitations of liability, so the above limitations or exclusions may not apply to you. Samsung's liability in any case shall be limited to the greatest extent permitted by law.

Samsung reserves the right, at its sole discretion, to change, modify, add or remove portions of any part of this manual at any time. It is your responsibility to check the manual periodically for changes. Your use of the manual will mean that you accept and agree to the terms and conditions set out in this manual. If you do not agree to comply with the terms and conditions of this manual, in whole or in part, please stop using this manual immediately.

# Memo

---



Scan the QR code\* or visit  
[www.samsung.com/spsn](http://www.samsung.com/spsn)  
to view our helpful  
How-to Videos and Live Shows

\* Requires reader to be installed on your  
smartphone

Scan this with your smartphone

U.S.A - Consumer Electronics - Mobile Phones	1-800-SAMSUNG (726-7864) 1-844-SAM-PAYS (726-7297)	<a href="http://www.samsung.com/support">www.samsung.com/support</a>
CANADA	1-800-Samsung (726-7864)	

