

Installation Guide

Replacement Water Filter Cartridge (RWFDISP)

Retain for Future Reference

IMPORTANT — PLEASE READ AND FOLLOW

- Before beginning, please read these instructions completely and carefully.
- Do not remove permanently affixed labels, warnings, or plates from the product. This may void the warranty.
- The installer should leave instructions with the consumer who should retain for local inspector's use and for future reference.

SAFETY INFORMATION

Read, understand, and follow all safety information contained in these instructions prior to installation and use of the Replacement Water Filter Cartridge (RWFDISP). Retain these instructions for future reference.

The RWFDISP is intended for use in filtering potable water in Built-in Side-by-Side Refrigerator/Freezers with Ice and Water Dispensers and 7 Series Integrated Refrigerators/Freezers.

EXPLANATION OF SIGNAL WORD CONSEQUENCES

 WARNING	Indicates a potentially hazardous situation, which, if not avoided, could result in death or serious injury and/or property damage.
CAUTION	Indicates a potentially hazardous situation, which, if not avoided, may result in property damage.

WARNING

To reduce the risk associated with choking:

- Do not allow children under 3 years of age to have access to small parts during the installation of this product.

To reduce the risk associated with the ingestion of contaminants:

- Do not use with water that is microbiologically unsafe or of unknown quality without adequate disinfection before or after the system. Systems certified for cyst reduction may be used on disinfected water that may contain filterable cysts.

CAUTION

To reduce the risk associated with property damage due to water leakage:

- **Read and follow** Use Instructions before installation and use of this system.
- Installation and use **MUST** comply with all state and local plumbing codes.
- **Protect from freezing**, remove filter cartridge when temperatures are expected to drop below 33° F (0.6° C).
- **Do not** install systems in areas where ambient temperatures may go above 110° F (43.3° C).
- **Do not** install on hot water supply lines. The maximum operating water temperature of this filter system is 100°F (37.8°C).
- **Do not** install if water pressure exceeds 120 psi (8.2 bar). If your water pressure exceeds 80 psi (5.5 bar), you must install a pressure limiting valve. Contact a plumbing professional if you are uncertain how to check your water pressure.
- **Do not** install where water hammer conditions may occur. If water hammer conditions exist you must install a water hammer arrester. Contact a plumbing professional if you are uncertain how to check for this condition.
- Where a backflow prevention device is installed on a water system, a device for controlling pressure due to thermal expansion must be installed.
- The disposable filter cartridge **MUST** be replaced every 6 months, at the rated capacity or sooner if a noticeable reduction in flow rate occurs.

REPLACING WATER FILTER FOR ICE/WATER DISPENSER MODELS

1. Locate water filter door. The door is located under the Meat Savor/Produce drawer handle. (See figure 1)
2. Push upper left corner of door to release latch and pull door downward
3. Turn filter cartridge counterclockwise until it releases from filter head.
3. Drain water from filter into sink and dispose of cartridge.
4. Wipe up excess water at filter location
5. Insert filter cartridge into circular opening in filter housing. Move filter cartridge horizontally until filter head is engaged.

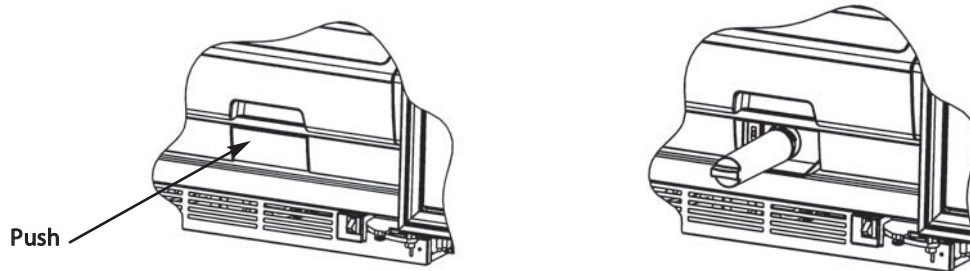

Figure 1
(42" W. model shown)

Rotate gently clockwise until filter stops.

6. Flush 2.5 gallons through filter before use (flush approximately 5 minutes). Continue to run water if water spurts occur until water runs steady. Additional flushing may be required in areas with poor quality water.

NOTE: Allow 1-2 minute delay in water dispersal to allow internal water tank to fill.

REPLACING WATER FILTER FOR 7 SERIES INTEGRATED REFRIGERATOR/FREEZER MODELS

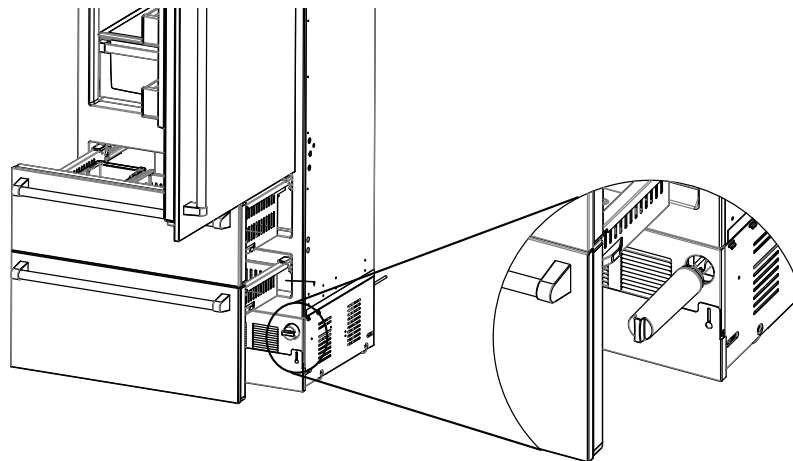

The water filter is located on the bottom right corner behind the lower freezer drawer.

1. To remove the water filter, push in and turn 1/4 counter clockwise, pull out.
2. Drain water from filter into sink and dispose of cartridge.
3. Wipe up excess water at filter location
4. To replace filter, insert filter cartridge into circular opening in filter housing. Push cartridge in until filter head is engaged . Turn 1/4 clockwise until filter stops, release.
5. Flush 2.5 gallons through filter before use (flush approximately 5 minutes). Continue to run water if water spurts occur until water runs steady. Additional flushing may be required in areas with poor quality water.

NOTE: Allow 1-2 minute delay in water dispersal to allow internal water tank to fill.

WHEN TO CHANGE THE WATER FILTER

IMPORTANT: Condition of the water and amount used determines life span of water filter cartridge. If water use is high, or if water is of poor quality, replacement may need to be more frequent.

The disposable filter cartridge **MUST** be replaced every 6 months, at the rated capacity or sooner if a noticeable reduction in flow rate occurs.

HOW TO ORDER REPLACEMENT FILTER CARTRIDGES

Replacement filters are available through your local Viking Range, LLC dealer. You may also order them by calling Preferred Service at 1-888-845-4641 or online at www.vikingrange.com in the US or brigade.ca in Canada

SYSTEM SPECIFICATION AND PERFORMANCE DATA SHEET

Model: Viking Water Filtration System

Use Replacement Cartridge: RWF-DISP

The concentration of the indicated substances in water entering the system was reduced to a concentration less than or equal to the permissible limit for water leaving the system as specified in NSF/ANSI Standard 42 and Standard 53.



System tested and certified by NSF International against NSF/ANSI Standard 42 and Standard 53 for the reduction of substances listed below.

Capacity 750 Gallons (2,838 Liters)

Contaminant Reduction Determined by NSF testing.

Substance Reduction	Average Influent	NSF specified Challenge Concentration	Avg % Reduction	Average Product Water Concentration	Max Permissible Product Water Concentration	NSF Reduction Requirements	NSF Test Report
Chlorine Taste and Odor	2.1 mg/L	2.0 mg/L ± 10%	97.6%	0.05 mg/L	N/A	≥ 50%	J-00121313
Nominal Particulate Class I, ≥0.5 to < 1.0 µm	9,100,000 pts/mL	At least 10,000 particles/mL	98.8%	111,817 pts/ml	N/A	≥85%	J-00099871
Asbestos	215 MF/L	10 ⁷ to 10 ⁸ fibers/L; fibers greater than 10 µm in length	>99%	<1 MF/L	N/A	≥99%	J-00099873
Atrazine	0.009 mg/L	0.009 mg/L ± 10%	94.4%	0.0005 mg/L	0.003 mg/L	N/A	J-00109716
Cyst*	170,000 cysts/L	Minimum 50,000 cysts/L	99.99%	1 cyst/L	N/A	≥99.95%	J-00109715
Lead @ pH 6.5	0.148 mg/L	0.15 mg/L ± 10%	99.3%	0.001 mg/L	0.010 mg/L	N/A	J-00121320
Lead @ pH 8.5	0.153mg/L	0.15 mg/L ± 10%	99.3%	0.001 mg/L	0.010 mg/L	N/A	J-00121322
Lindane	0.002 mg/L	0.002 mg/L ± 10%	98.8%	0.00002mg/L	0.0002 mg/L	N/A	J-00107051
Mercury @ pH 6.5	0.006 mg/L	0.006 mg/L ± 10%	95.1%	0.0003 mg/L	0.002 mg/L	N/A	J-00121324
Mercury @ pH 8.5	0.006 mg/L	0.006 mg/L ± 10%	95.0%	0.0003 mg/L	0.002 mg/L	N/A	J-00122998
Toxaphene	0.016 mg/L	0.015 mg/L ± 10%	93.8%	0.001 mg/L	0.003 mg/L	N/A	J-00121328

* Based on the use of *Cryptosporidium parvum* oocysts

Application Guidelines/Water Supply Parameters

Capacity:	Certified for up to 750 gallons (2,838 L); up to six months
Pressure Requirement:	20 - 120 psi (1.4 - 8.2 bar)
Temperature:	33-100°F (0.6 - 37.8°C)
Flow rate:	0.78 gpm (2.9 L/min)
Water Supply:	Potable Water

Check for compliance with the state and local laws and regulations. Note: While the testing was performed under standard laboratory conditions, actual performance may vary. Must be installed and operated in accordance with manufacturer's recommended procedures and guidelines. Installation instructions, parts and service availability, and standard warranty are included with the product when shipped. This drinking water system must be maintained according to manufacturer's instruction, including replacement of filter cartridges.

Manufactured by:
3M Purification Inc.
3130 Lexington Avenue South,
Eagan, MN 55121

Viking Range, LLC
111 Front Street • Greenwood, Mississippi 38930 USA • (662) 455-1200
Specifications subject to change without notice.
For more production information, call 1-888-845-4641