

PRESRV™

REFRIGERATOR
DRAWERS

DUAL ZONE



From snacks for the kids to the freshest produce to party-ready food and drinks, these stylish under-counter Panel Ready Dual Zone Refrigerator Drawers beautifully harmonize with your cabinetry and give you additional cold storage right where you need it. This large capacity refrigerator

maintains two distinct temperature zones and is loaded with features like Quick Chill to instantly lower overall refrigerator temperature; handy temperature presets; full-extension, soft-close drawers and the ability to blend into your kitchen cabinetry seamlessly.

ZEPHYR

ZEPHYRONLINE.COM



Quick Chill



Shown with overlay panel and custom handle (not included)

How Presrv™ Stands Out:



PreciseTemp™

Multiple internal sensors help maintain accurate temperatures and increase overall performance



Drawer Organizers

Customizable drawer organizers help keep everything in its place



Active Cooling Technology

An on-board computer controls active cooling fans to provide temperature stability and even cooling



Soft-Close Drawers

Close more smoothly and quietly to prevent shifting of drawer contents

Overlay Panel Dimensions*

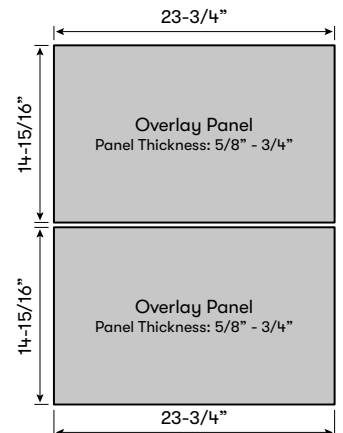

*panel not included

MODEL

Dual Zone Refrigerator Drawers	PRRD24C2AP
Size	24"
Dimensions	23-7/8"W x 33-7/8"H x 24"D
Weight	121 lbs.
Installation Type	Compact / Built-in
Refrigerant Type	R600a

FEATURES

Volume	5.1 cu/ft
Temperature Range	33° - 65° F (each zone)
Sound Level	38 dBA
Exterior Drawer Finish	Panel-Ready, no handle
Interior Drawer Finish	Stainless Steel
Exterior Cabinet Finish	Black
Interior Cabinet Finish	Black
Full-Extension Drawers	Yes
Soft-Close Drawers	Yes
Removable Silicone Drawer Mats	Yes
Drawer Organization	Adjustable Bar Dividers + Transparent Drawer Tray
Lighting	3-Color LED Lighting Cloud White, Deep Blue, Amber
Controls	3-Color Electronic Touch
Preset Temperature Modes	Produce, Beverage, Wine
Quick Chill	Yes, for faster cooldown
Door Open Alarm	Yes
Dual Evaporators	Yes
Sabbath Mode	Yes
ENERGY STAR® Certified	Yes
PreciseTemp™	Yes
Active Cooling Technology	Yes

AC POWER	115V, 60Hz at Max. 1.5A
----------	-------------------------

OPTIONAL ACCESSORIES

Contemporary Handle*	PRHAN-C101 (Stainless Steel, x1)
Contemporary Handle*	PRHAN-C102 (Brushed Gold, x1)
Contemporary Handle*	PRHAN-C104 (Matte Black, x1)
Pro Handle*	PRHAN-C001 (Stainless Steel, x1)
Pro Handle*	PRHAN-C003 (Brushed Gold, x1)
Pro Handle*	PRHAN-C004 (Matte Black, x1)

WARRANTY	2 years parts, 2 years labor 5 years compressor
----------	--

*1 handle included, 2 handles needed.

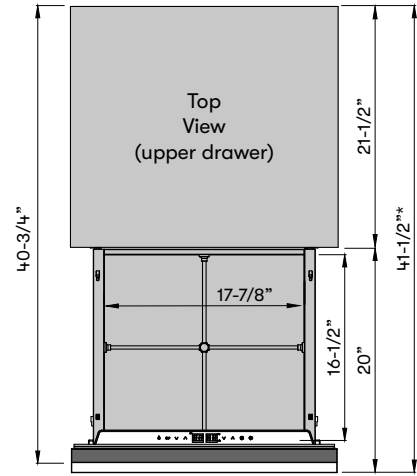

*Depth with 3/4" thick overlay panel

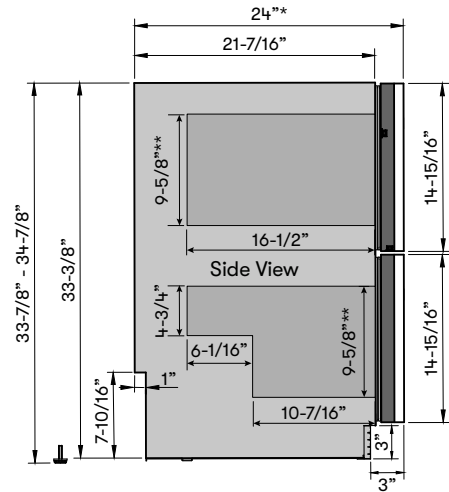

*Depth with 3/4" thick overlay panel
** Maximum clearance height inside drawers is 12"

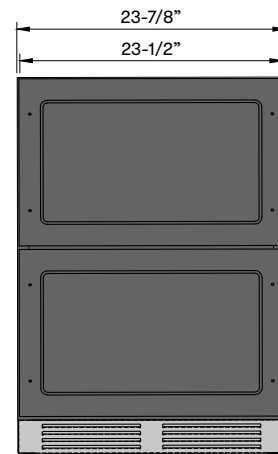

Transforming the Kitchen through Design, Discovery, and Care

Specifications subject to change, check zephyronline.com for up-to-date information.
Zephyr | 2277 Harbor Bay Parkway, Alameda, CA 94502 | 888.880.8368

