

30" Panel-Ready SlimTech Column Refrigerator JBRFSR30RX (Right Swing)



Features

Daring Obsidian Interior

Inspired by volcanic glass, this dark finish erupts with reflective, high-contrast style. Let fine foods emerge like vibrant art, begging to be devoured.

Ecliptic Lighting

Live beyond the shadow, live beyond puck lighting. Over 650 LEDs frame and fill your column, coming alive at a touch of the controls. Each item illuminates in dramatic glory.

Trinity Cooling

Three zones. Three precision sensors. Calibrated every second. Command temperatures and humidity in each zone with an exposed air tower for total control.

Remote Access

Open door. Power outages. Filter changes. Connect to WiFi for real-time notifications and control your columns from anywhere. Tap and swipe on both iOS and Android devices.

Solid Glass and Metal

All-metal bins and shelf frames. Thick, naturally odor-resistant solid glass. A forcefield at the edge that prevents spills. To hell with cheap plastic in luxury designs.



Accessories

| | | |
|--|--|----------------------------------|
| Handle Kits | RISE™ NOIR™ | W11220302 W11220303 |
| Panel Kits | RISE™ NOIR™ | JKCPR301GL JKCPR301CM |
| Join Kits | LH to RH LH to LH RH to RH | JAJ31HSS JAJ12HSS JAJ11HSS |
| Toe Kicks <i>Key: JACxxyyHB/S</i> <i>xx = left unit width</i> <i>yy = right unit width</i> <i>B/S = black or stainless steel</i> | JAC1830H JAC2430H JAC3018H JAC3030H | JAC3024H JAC3630H JAC3036H |
| Water Filter | EDR2RXD1 | |

Product Details

| | |
|-------------------|--------------------------------|
| Dimensions | 29 3/4"W x 83 1/2"H x 23 7/8"D |
| Cutout Dimensions | 30"W x 84"H x 25" D |
| Capacity | 17.0 Cu Ft |
| Water Dispenser | Filtered Internal Water |
| Shelves | 3 Adjustable, 1 Fixed |
| Drawers | 3 Temp Controlled |
| Door Bins | 4 Adjustable Gallon |
| Energy Rating | 330 kWh |

30" Panel-Ready SlimTech Column Refrigerator JBRFSR30RX (Right Swing)



Water & Electrical

WATER SUPPLY REQUIREMENTS

| | |
|--|---|
| Water Pressure | 30 – 120 psi (207 – 827 kPa) |
| Water Pressure to Reverse Osmosis System | Minimum 40 – 60 psi (276 – 414 kPa) |
| Excess Water Line for Connection | 30" (76.2 cm) |
| Supply | 1/4" OD copper, braided stainless steel or PEX tubing |

Recommended Grounding Method

A 115 V, 60 Hz, AC-only 15 A or 20 A fused, grounded electrical supply is required. Max amp draw for one column is 3.9 A. It is recommended that a separate circuit serving only your refrigerator and approved accessories be provided. Use an outlet that cannot be turned off by a switch. Do not use an extension cord.

Custom Panel Dimensions

| | |
|----------------|------------------------|
| Thickness | 3/4" (1.9 cm) max. |
| Weight | 60 lbs. (27.2 kg) max. |
| Typical Height | 80" (203.2 cm) |

CUSTOM PANEL WIDTH

⚠ CAUTION

Pinch Hazard

Installation of door panels with less than a 3/8" (0.95 cm) gap between the door panel and the adjacent cabinet increases the risk of potential pinching.

| MODEL | FLUSH WIDTH |
|-------|-------------------|
| 18" | 17-3/4" (45.1 cm) |
| 24" | 23-3/4" (60.3 cm) |
| 30" | 29-3/4" (75.6 cm) |
| 36" | 35-3/4" (90.8 cm) |

Cutout Dimensions

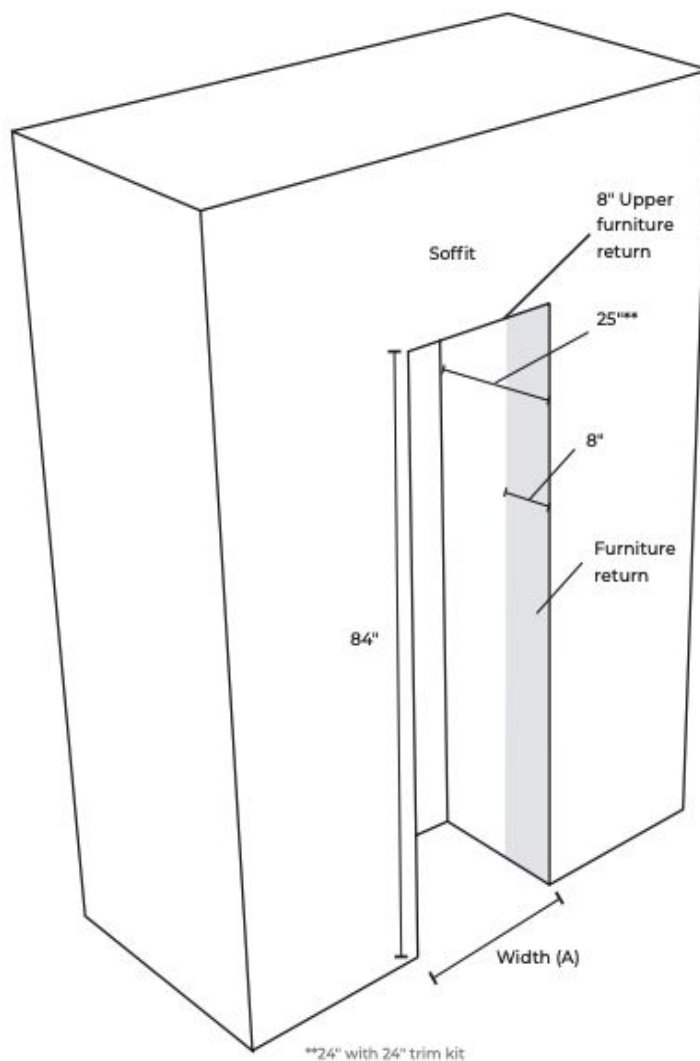

Opening Width (A)

| | |
|-----|---------------|
| 18" | 18" (45.7 cm) |
| 24" | 24" (61 cm) |
| 30" | 30" (76.2 cm) |
| 36" | 36" (91.4 cm) |