

HR 1632-3

36" Induction Range

Features:

- M-Touch display - intuitive touch interface
- 5-zone induction cooktop including two PowerFlex zones and 1 round zone
- Moisture Plus for perfect baking and roasting results
- Wireless Precision Probe - precisely monitor food temperature
- WifiConn@ct - monitor your appliances from your mobile device
- Motion React - appliance reacts to you when approached
- Automatic programs - master new recipes easily

Included:

- 2x Pyrofit (self clean ready) Wire Racks
- 1x Pyrofit (self clean ready) Telescopic Rack
- 1x PerfectClean Baking Tray
- 1x PerfectClean Perforated Baking Tray



MATERIAL

12535260

SPECIFICATIONS	
Overall Unit Dimensions	35 ¹⁵ / ₁₆ " (913 mm) W x 35 ¹ / ₂ " – 37" (902 – 940 mm) H x 27 ⁵ / ₈ " (702 mm) D [Depth to bullnose]
Niche	
Minimum Cabinet Niche Opening	36 (915 mm) W x 35 ¹ / ₂ " (902 mm) H
Plumbing	
Plumbing Requirements	An inline water filter required. Do not connect to a Reverse Osmosis (RO) water system. Connect to a cold water supply only with a shut-off valve. The water pressure must be between 14.5 and 145 psi (1 and 10 bars).
Plumbed Hose Connection	Supplied hose: flexible braided 4'11" (1.5 m) with 3/8" O.D. compression fitting for connection to a shut off valve. Total hose length must not exceed 24.5 ft. (7.5 m).
Electrical	
Electrical Requirements	120/208-240V, 60Hz, 50 Amps
Power Cord	NEMA 14-50 plug, 5 ft (1.52 m)
Shipping	
Shipping Weight	439 lbs (199 kg)

PRODUCT DIMENSIONS

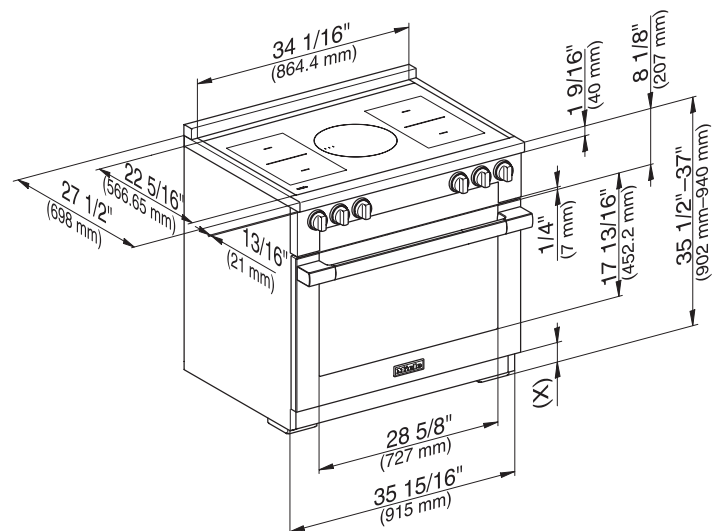

ADDITIONAL PRODUCT DIMENSIONS

Rear View

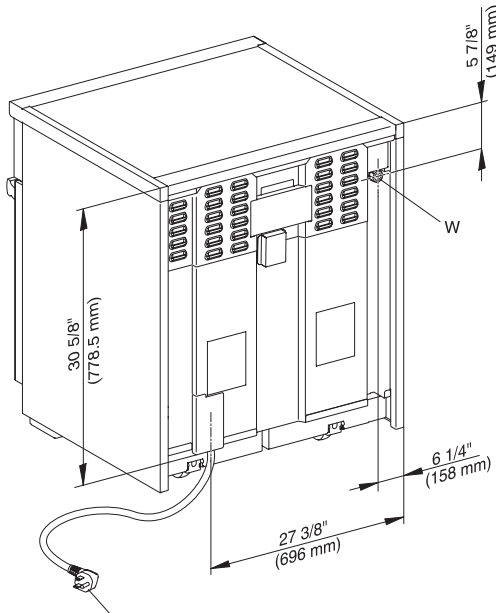

Side View

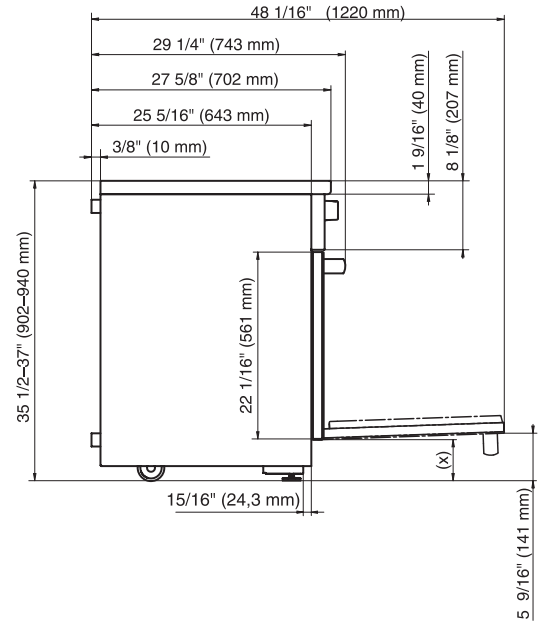

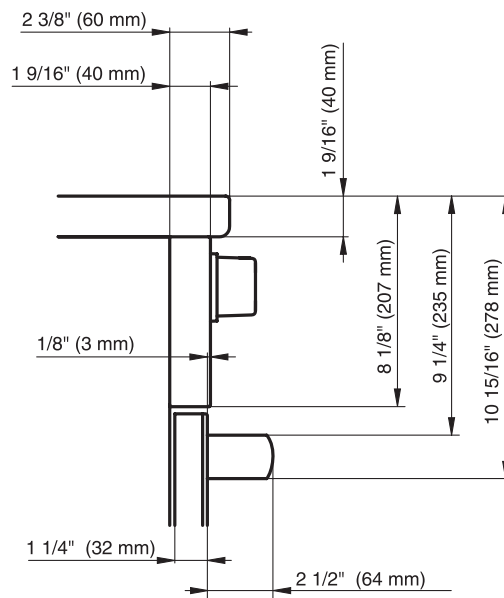

(x) = Toe-kick height adjustment 5" - 6 1/2" (127 mm - 165.1 mm)
 E = Electrical connection
 W = Water connection

Bullnose Details



NICHE DETAILS

Cooking zone data

Size of pan base (min. to max.) ¹			Setting	Max. power at ²	
round ∅	square □□	208 V, 60 Hz		240 V, 60 Hz	
Round cooking zone					
	7 1/16"–11" (18–28 cm)	—	Normal	2,400 W	2,600 W
			TwinBooster Level 1	2,750 W	3,000 W
			TwinBooster Level 2	3,350 W	3,700 W
PowerFlex cooking zones ³					
	5 7/8"– 9 1/16" (15–23 cm)	5 7/8" x 5 7/8"– 9 1/16" x 7 1/2" (15 x 15 cm– 23 x 19 cm)	Normal	1,900 W	2,100 W
			TwinBooster Level 1	2,750 W	3,000 W
			TwinBooster Level 2	3,350 W	3,700 W
PowerFlex cooking areas					
	8 11/16"–9" (22–23 cm)	8 11/16" x 8 11/16"– 9 1/16" x 15 3/8" (22 x 22 cm– 23 x 39 cm)	Normal	3,100 W	3,400 W
			TwinBooster Level 1	4,350 W	4,800 W
			TwinBooster Level 2	6,700 W	7,400 W
			Total	9,900 W	11,200 W

1 Cookware with any base diameter within the given range may be used.

2 The power indicated may vary depending on the size and material of the cookware used.

3 The two rear PowerFlex cooking zones are electrically connected, as are the two front PowerFlex cooking zones. PowerFlex cooking zones between which there is an electrical connection cannot be operated at the same time with high power (e.g., TwinBooster).

PAIRING WITH A HOOD FAN

Unlike all-gas and DF ranges, induction ranges do not necessitate installation of a range hood (DAR) above due to different heat transfer.

Miele HR 1432-3 I and 1632-3 I Induction Ranges can be paired with any hood fan type 36" or wider.

HR 1432-3 i, HR 1632-3 i

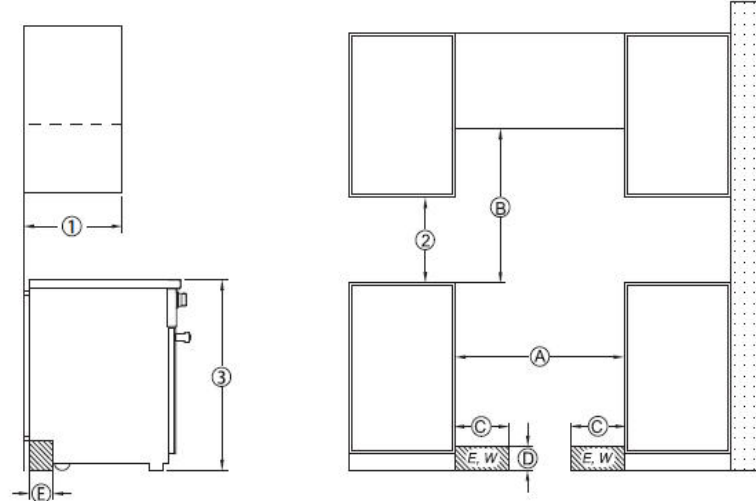

ⓐ, ⓑ, ⓓ The shaded area represents the installation area for the connections:

E = Electrical connection,

W = Plumbed water connection (HR 1632-3 i only)

HR 1432-3 i, HR 1632-3 i

Position	Dimension	Description	Position of the wall socket
①	13" (330 mm)	Maximum depth of wall cabinet	
②	18" (457 mm)	Minimum safety distance to bottom edge of wall cabinet	
③	35 1/2"–37" (901–940 mm)	Distance from floor to top of cooktop surface	
Ⓐ	min. 36" (915 mm)	Niche width	
Ⓑ	min. 36" (915 mm)	Minimum safety distance between the top of the cooktop surface and the bottom of an unprotected combustible surface.	
	30" (762 mm)	Minimum safety distance to a protected combustible surface or when a Miele ventilation hood is installed.	
For all other ventilation hoods please consult the manufacturer's specifications for required distances.			
Ⓒ	approx. 13 1/16" (332.5 mm)	Maximum connection width right and left	Position of the wall socket
Ⓓ	approx. 4 1/2" (115 mm)	Maximum connection height	
Ⓔ	approx. 2 13/16" (72 mm)	Maximum connection depth	

Please observe a minimum safety distance of at least 12" (305 mm) from combustible surfaces located behind the appliance. For zero clearance installation the Miele backguards will satisfy the required minimum safety distance from combustible surfaces. The Miele backguard is available in 12" (305 mm) or 20" (508 mm) heights.

Heating type		User convenience		Cleaning convenience	
All electric	•	Networking with Miele@home	•	Stainless steel front with partial CleanTouch Steel finish	•
Cooktop	Induction	Metal knobs	•	Self Clean oven	•
Construction type		Backlit control knobs	•	Catalyzer	•
Range	•	Ergonomic swivel handle	•	Catalyzer	Heated
Appliance width in inches	36	Motorized lift-up control panel	•	Cooktop surface	Ceramic surface
Operating modes		Clock synchronization	•	Safety	
Surround	•	Sabbath Program	•	Appliance cooling system with touch-cool fronts	•
Maxi Broil	•	Safety shut-off	•	Safety shut-off	•
Moisture Plus	•	Language Options	•	System lock	•
Convection Bake	•	Audible signal when desired temperature is reached	•	Door contact switch	•
Convection Roast	•	MyMiele	•	Door lock during SelfClean	•
Intensive	•	Timed bursts of steam	•	Technical data	
Auto Roast	•	Time-of-day display	•	Appliance height in mm (min.)	35 1/2 (902)
Convection Broil	•	Date display	•	Dimensions in mm (depth) with bullnose	27 5/8 (702)
Broil	•	Timer	•	Appliance height in mm (max.)	37 (940)
Browning	•	Programmable cooking duration	•	Fresh-water connection for Moisture Plus	•
Bake	•	Actual temperature display	•	Fresh-water connection for Moisture Plus	1.5m
Slow Roasting	•	Recommended temperatures	•	Appliance width in mm	35 15/16 (913)
Defrost	•	Favourites	•	Voltage in V	120
Special modes	•	Individual settings	•	Voltage convertible in V	240/208
Design		Appliance door		Fuse rating in A	50
Colour	CleanTouch Steel	CleanGlass door	•	Number of phases	1
Oven display	M Touch	Door contact switch	•	Accessories supplied	
Convenience features		SoftClose oven door	•	Anti-splash insert	1
Wireless precision probe	•	Oven cavity		Self Clean ready wire rack	2
Keeping warm	•	Oven capacity in l	5.76 (163) ft³ (l)	Self Clean ready wire rack with rail system	1
Crisp function	•	Number of oven shelf levels	6	Self Clean ready side racks	1
		Number of halogen lights	double	Perforated Gourmet baking tray with PerfectClean	1
		TwinPower Convection Fans	•		
		Efficiency and sustainability			
		Automatic residual heat utilization	•		
		Power-saving lighting circuit	•		
		Rapid PreHeat	•		