

36" Overhead Range Hood

Ventilation

Available Products: FHWC3640MS

Available Colors: Stainless Steel

Version: 08/22



Product Specifications

Ventilation System

Exhaust Fan Speeds	3
Maximum Air Flow Capacity	300 CFM
Charcoal Filter Included	Yes

Surface Light System

Lighting Type	Halogen
Number of Lights	2

Electrical Specifications

Voltage Rating	120 V
----------------	-------

Certifications and Approvals

ADA Compliant	No
---------------	----

Controls

Control Type	Push Button
--------------	-------------

Dimensions and Volume

Height	5"
Width	36"
Depth	18 5/8"

General Specifications

Prop 65 Label	Yes
Sound Level	68.2 dBA
Warranty - Labor	1 Year
Warranty - Parts	1 Year

Safety Certifications and Approvals

CSA Listed	No
UL Listed	Yes
ETL Listed	No

Installation Diagram

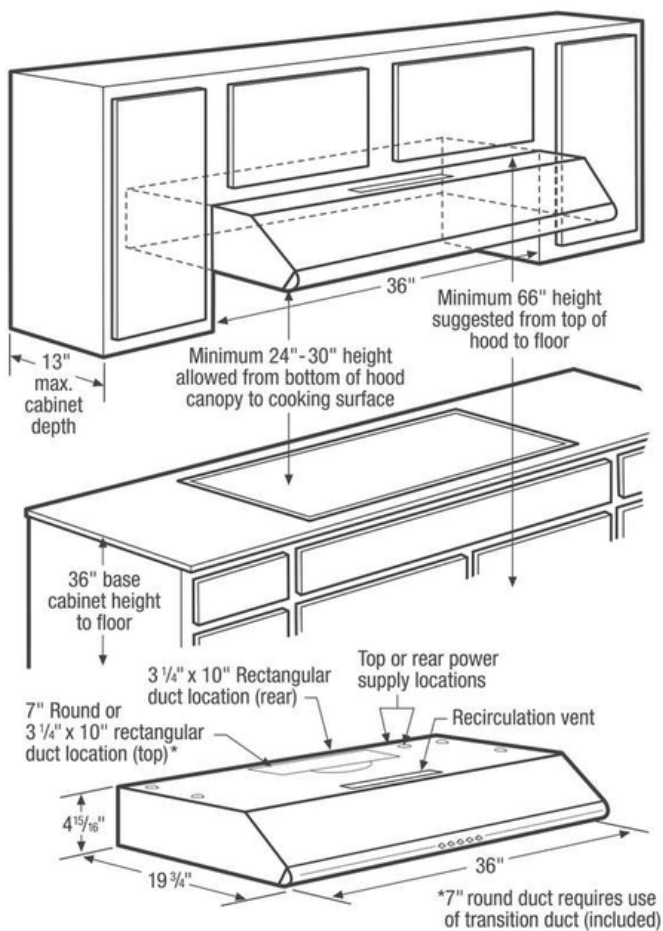

Exhaust Options

Vent hood can be vertically or horizontally ducted outside using round or rectangular duct; or recirculated inside with no ducting required. For detailed duct preparation and installation specifications, refer to installation instructions on web.

Outside Vertical – 7" Round Duct Cabinet Bottom

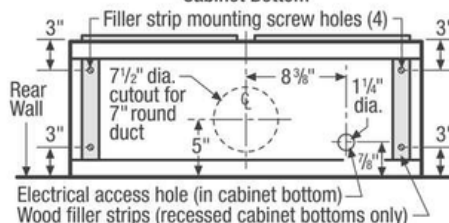

Outside Vertical – 3 1/4" x 10" Rectangular Duct Cabinet Bottom

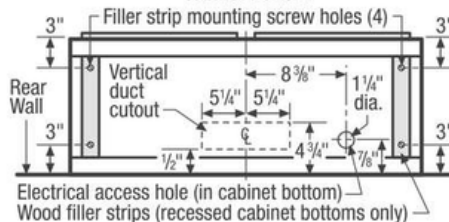

Outside Horizontal – 3 1/4" x 10" Rectangular Duct Cabinet Front

