

CONTENTS

- 12 Screw, #8-15X1/2 6 Lobe TR HD
- 2 Bolt, #10-24X1/2 6 Lobe FL HD
- 2 Bracket, Center Support
- 1 Template, Door (Drawer) Panel Drill
- 2 Washer, Special Center Spr

NOTE: This package is for 36" (914mm) wide drawer panels to be used on an Integrated Unit that may have a center pull and the door panel is flexible at the center.

INSTALLATION

- 1 Install special center support washer (provided) to the front of the drawer by inserting the #10-24 x 1/2" 6 lobe flat head bolt (provided) through the special center support washer and into the rivnut that is installed in the center of all 36" (914mm) drawer shells (See Figure 1).

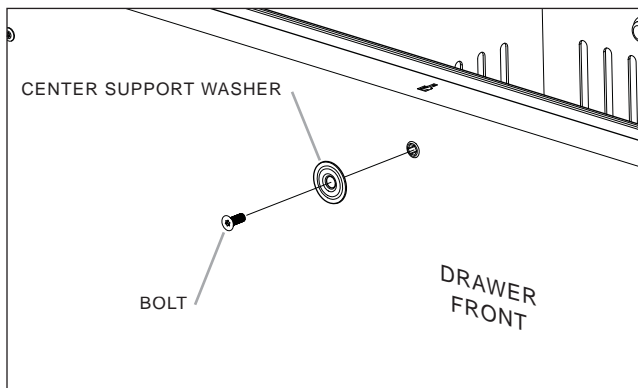

Figure 1.

- 2 Place drawer panel face down on a protected work surface.
- 3 Identify drawer panel side of template. It includes hole locations for both the upper and lower drawer panels.
- 4 Position drawer panel template along the top of drawer panel and drill pilot holes in locations for either the upper or lower drawer panel as indicated on template. Do this for both sides of drawer panel.
- 5 Position template to mark location of center mounting bracket holes (See Figure 2). Then drill pilot holes and install panel mounting center bracket using three #8 x 1/2" screws (provided) to the back of panel. Now, using the panel mounting center bracket, drill pilot holes at other side of bracket and install three #8 x 1/2" screws.

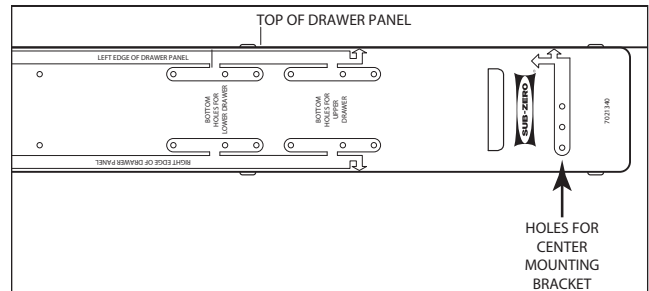

Figure 2.

- 6 Partially insert a #8 x 1/2" screw into the second hole down from the top on one side of the panel, leaving the screw head approximately 3/16" (4mm) proud of panel (See Figure 3).
- 7 Using the partially driven screw, hang the drawer panel on the bracket on the same side of the drawer. This may be easier with drawer partially open (See Figure 3).

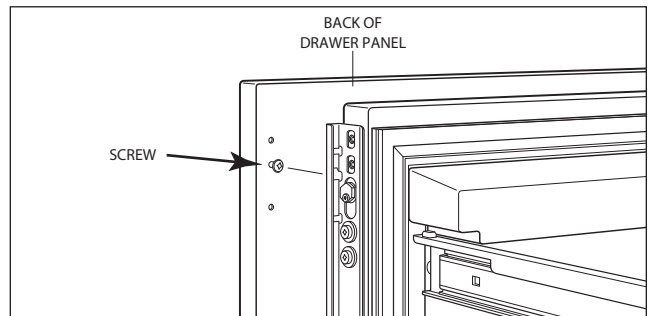

Figure 3.

- 8 Rotate the drawer panel up to align and engage the panel mounting center bracket on the panel with the special center support washer on the drawer front. (See Figure 4)
- 9 Install remaining screws through the brackets on each side of the drawer into the panel, but do not tighten completely. This will allow for easier side to side adjustment of the panel later.

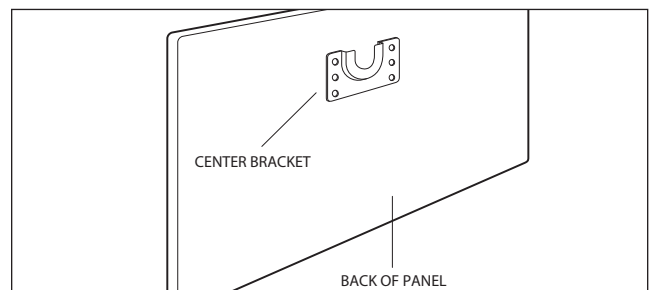

Figure 4.

