

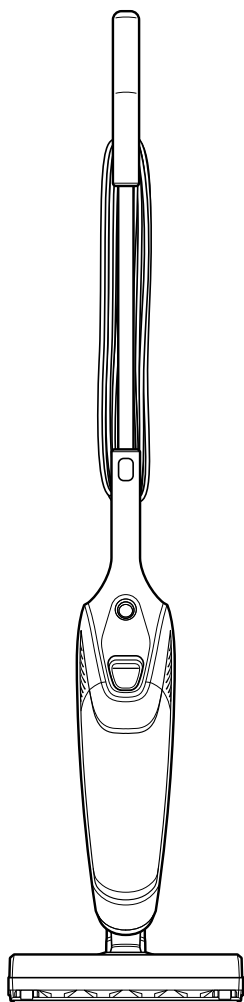

**FEATHERWEIGHT™ POWERBRUSH  
STICK VACUUM**

2773, 3381 SERIES



# IMPORTANT SAFETY INSTRUCTIONS



## READ ALL INSTRUCTIONS BEFORE USING YOUR APPLIANCE.

Always connect to a polarized outlet (one slot is wider than the other). Unplug from outlet when not in use and before conducting maintenance. When using an electrical appliance, basic precautions should be observed, including the following:



## WARNING

### TO REDUCE THE RISK OF FIRE, ELECTRIC SHOCK OR INJURY:

- » Always connect to a polarized outlet (one slot is wider than the other).
  - Do not modify the polarized plug to fit a non-polarized outlet or extension cord.
- » Do not leave vacuum cleaner when it is plugged in. Unplug from outlet when not in use and before servicing.
- » Do not use outdoors or on wet surfaces.
- » Do not allow to be used as a toy. Close attention is necessary when used by or near children.
- » Do not use for any purpose other than described in this user guide. Use only manufacturer's recommended attachments.
- » Do not use with damaged cord or plug. If appliance is not working as it should, has been dropped, damaged, left outdoors, or dropped into water, have it repaired at an authorized service center.
- » Do not pull or carry by cord, use cord as a handle, close a door on cord, or pull cord around sharp edges or corners. Do not run appliance over cord. Keep cord away from heated surfaces.
- » Do not unplug by pulling on cord. To unplug, grasp the plug, not the cord.
- » Do not handle plug or vacuum cleaner with wet hands.
- » Do not put any object into openings. Do not use with any opening blocked; keep openings free of dust, lint, hair, and anything that may reduce air flow.
- » Keep hair, loose clothing, fingers, and all parts of body away from openings and moving parts.
- » Turn OFF all controls before plugging or unplugging vacuum cleaner.
- » Use extra care when cleaning on stairs.
- » Do not use to pick up flammable or combustible materials (lighter fluid, gasoline, kerosene, etc.) or use in areas where they may be present.
- » Do not use vacuum cleaner in an enclosed space filled with vapors given off by oil-based paint, paint thinner, some moth-proofing substances, flammable dust, or other explosive or toxic vapors.
- » Do not use to pick up toxic material (chlorine bleach, ammonia, drain cleaner, etc.).
- » Do not pick up anything that is burning or smoking, such as cigarettes, matches or hot ashes.
- » Do not use without filters in place.
- » Do not pick up hard or sharp objects such as glass, nails, screws, coins, etc.
- » Use only on dry, indoor surfaces.
- » Keep appliance on a level surface.
- » Do not carry the vacuum cleaner while it is running.
- » Always turn OFF this appliance before connecting or disconnecting motorized nozzle
- » Plastic film can be dangerous. To avoid danger of suffocation, keep away from children
- » If the appliance has a handheld accessory like pet brush, motor driven head, etc. the user shall avoid entrapment.

## SAVE THESE INSTRUCTIONS

THIS MODEL IS FOR HOUSEHOLD USE ONLY.

COMMERCIAL USE OF THIS MACHINE VOIDS THE MANUFACTURER'S WARRANTY.

## THIS APPLIANCE HAS A POLARIZED PLUG

To reduce the risk of electric shock, this appliance has a polarized plug (one blade is wider than the other). This plug will fit in a polarized outlet only one way. If the plug does not fit fully in the outlet, reverse the plug. If it still does not fit, contact a qualified electrician to install a proper outlet. Do not change the plug in any way.

# Thanks for buying a BISSELL® vacuum!

We love to clean and we're excited to share one of our innovative products with you. We want your vacuum to work like new for the years to come, so this guide has tips on how to use, maintain and, if there's a problem, troubleshoot.

Your vacuum needs a little assembly before getting to work, so flip to the "Assembly" section and let's get started!

Product View .....	3	Warranty .....	7
Assembling and Using your Vacuum .....	4	Service.....	7
Power Cord Storage .....	4	Register Your Product.....	8
Emptying the Dirt Tank.....	5	Parts & Supplies.....	8
Cleaning the Brush Roll .....	6		

## Product View

- 1. Hand Grip
- 2. Cord Wrap
- 3. Power Cord
- 4. Handle
- 5. Quick Release Handle
- 6. Hand Vacuum Grip
- 7. Power Switch
- 8. Dirt Tank Latch
- 9. Filter (inside Dirt Tank)
- 10. Dirt Tank
- 11. Removable Floor Nozzle
- 12. Model Number and Serial Number
- 13. Brush Roll
- 14. Floor Nozzle Latch

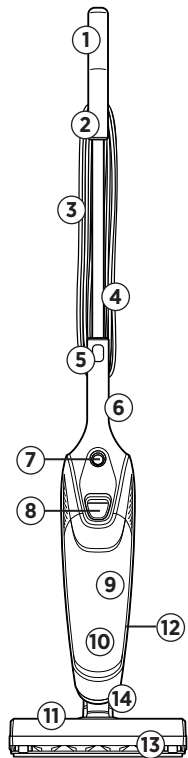

# Assembling and Using your Vacuum

## **WARNING**

Do not operate vacuum with damp or wet filters or without all filters in place.

1



To use as a floor vacuum, insert handle

2

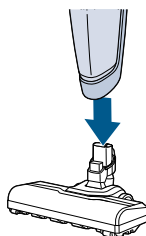

Then, attach the removable floor nozzle by inserting it into the opening at the bottom of the dirt tank. Press firmly to secure in place.

3

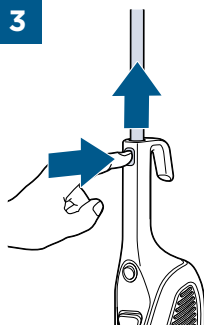

To use as a hand vacuum, push the button to remove the handle. Ensure the cord is not wrapped or you will not be able to remove the handle.

4

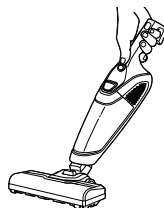

The removable floor nozzle may be used with the hand vacuum for multi-purpose cleaning. To attach the nozzle, insert it into the opening at the bottom of the dirt tank. Press firmly to secure in place.

## Power Cord Storage



Turn vacuum OFF and unplug power cord by grasping the polarized plug, NOT the cord, and disconnecting it from the outlet. Loop power cord around cord wraps on the handle and clip the molded plug to power cord to secure.

# Emptying the Dirt Tank

## WARNING

» To reduce the risk of electrical shock, turn power switch OFF and disconnect polarized plug from electrical outlet before performing maintenance or troubleshooting checks.

» Do not operate vacuum with damp or wet filters or without all filters in place.

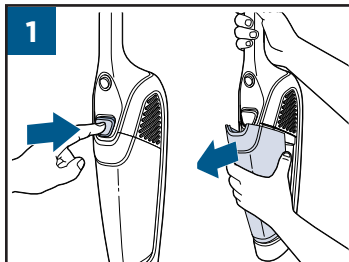

1 Turn the vacuum off and hold it vertically, pressing the dirt tank release latch. Gently pull the dirt tank from the hand vacuum.



2 Grip and remove the filter.

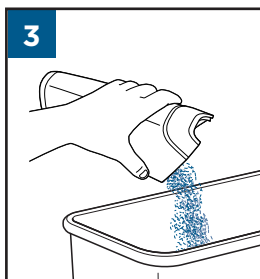

3 Empty contents of dirt tank into a trash bin, and gently tap against side to remove any build up.

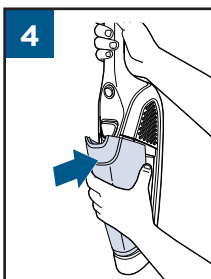

4 Replace filter. Attach dirt tank to vacuum by securely fitting onto hand grip. Make sure dirt tank is correctly secured.

**NOTE:** The dirt tank may be rinsed with warm water and a mild detergent if needed. The dirt tank must be thoroughly dried before replacing.

# Cleaning the Filter

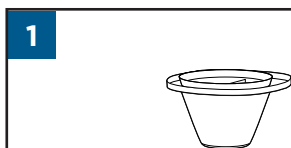

1 Follow the steps above to remove dirt tank and filter. To clean the filter, shake it over a trash bin and gently tap against side until all debris is gone.



2 Return filter to dirt tank and follow instructions above to return the dirt tank to vacuum, making sure it is correctly secured.

**NOTE:** After heavy usage, you may clean the filter by washing it gently by hand in warm water and mild dish detergent. Rinse thoroughly and let dry 24 hours before replacing it. If filter is torn, replace it with a new filter.

# Cleaning the Brush Roll

## WARNING

To reduce the risk of electrical shock, turn power switch OFF and disconnect polarized plug from electrical outlet before performing maintenance or troubleshooting checks.

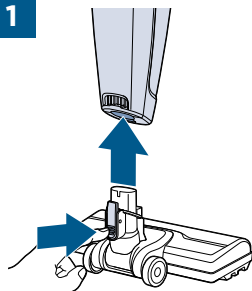

Make sure the vacuum is OFF. Press the release button to disconnect the removable floor nozzle from the hand vacuum.

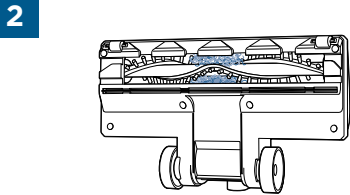

Turn the removable floor nozzle over to remove any debris or to clear a clog in your brush roll.

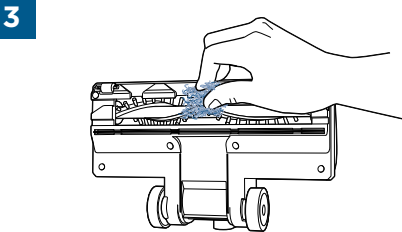

Remove the contents clogging the brush roll.

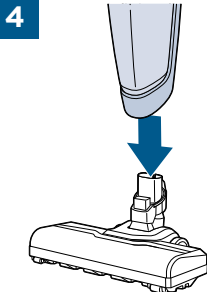

Secure the removable floor nozzle back into the hand vacuum.

**NOTE:** The brush roll may stall if clogged. Unplug the machine and let the it cool down. Once cool, you can plug it back in and resume cleaning.

# Troubleshooting

Problem	Possible causes	Remedies
<b>Vacuum cleaner won't run</b>	Power cord not firmly plugged in.	Check electrical outlet.
	Blown household fuse or breaker.	Check/replace fuse; reset breaker.
<b>Vacuum cleaner won't vacuum effectively</b>	Filter missing, clogged, wet, or dirty.	Follow instructions for cleaning filter.
	Dirt tank clogged.	Follow instructions for emptying dirt tank.
<b>Dust blows out of air vent</b>	Filter not properly secured to filter frame.	Follow instructions for replacing filter above.
<b>Brush roll won't spin</b>	Clog in brush roll area.	Follow instructions for "Cleaning the Brush Roll" above.
	Brush was stalled.	Unplug the machine and let it cool down.

# Warranty

This warranty gives you specific legal rights, and you may also have other rights which may vary from state to state. If you need additional instruction regarding this warranty or have questions regarding what it may cover, please contact BISSELL® Consumer Care by email or telephone as described below.

It may be necessary to obtain some of your personal information, such as a mailing address, to fulfill terms of this warranty. Any personal data will be handled pursuant to BISSELL's Privacy Policy, which can be found online at [www.BISSELL.com/privacy-policy](http://www.BISSELL.com/privacy-policy).

## One-Year Limited Warranty

Subject to the **\*Exceptions and Exclusions from the Terms of the Limited Warranty**, upon receipt of the product BISSELL will repair or replace (with new, refurbished, lightly used, or remanufactured components or products), at BISSELL's option, free of charge from the date of purchase by the original purchaser, for one year, any defective or malfunctioning part. See information below on "If your BISSELL product should require service".

This warranty applies to product used for personal, and not commercial or rental, service. This warranty does not apply to fans or routine maintenance components such as filters, belts or brushes. Damage or

malfunction caused by negligence, abuse, neglect, unauthorized repair, or any other use not in accordance with the user guide is not covered. This warranty will only be valid if the product is used in the same country in which it was sold.

BISSELL is not liable for incidental or consequential damages of any nature associated with the use of this product. BISSELL's liability will not exceed the purchase price of the product.

**Some states do not allow the exclusion or limitation of incidental or consequential damages, so the above limitation or exclusion may not apply to you.**

## \*Exceptions and Exclusions from the Terms of the Limited Warranty

This warranty is exclusive and in lieu of any other warranties, either oral or written. Any implied warranties, which may arise by operation of law, including the implied warranties of merchantability and fitness for a particular purpose, are limited to the one-year duration from the date of purchase as described above.

Some states do not allow limitations on how long an implied warranty lasts, so the above limitation may not apply to you.

**NOTE:** Please keep your original sales receipt. It provides proof of date of purchase in the event of a warranty claim.

# Service

**Please do not return this product to the store.** Other maintenance or service not included in the manual should be performed by an authorized service representative.

**If your BISSELL product should require service:** Visit [support.BISSELL.com](http://support.BISSELL.com) or call 1-800-237-7691 for warranty information, BISSELL Authorized Service Centers, and replacement parts.

# Register Your Product

Registering is quick, easy and offers you benefits over the lifetime of your product.

## **BISSELL® Rewards Points**

Automatically earn points for discounts and free shipping on future purchases.

## **Faster Service**

Supplying your information now saves you time should you need to contact us with questions regarding your product.

## **Product Support Reminders and Alerts**

We'll contact you with any important product maintenance reminders and alerts.

## **Special Promotions**

Optional: Register your email to receive notice of offers, contests, cleaning tips, and more!

**Visit [BISSELL.com/registration](https://www.bissell.com/registration)!**

# Parts & Supplies

**For Parts and Supplies, go to [BISSELL.com](https://www.bissell.com)** and enter your model number in the search field.

## We're Waggin' Our Tails!

BISSELL proudly supports BISSELL Pet Foundation® and its mission to help save homeless pets. When you buy a BISSELL product, you help save pets, too. We're proud to design products that help make pet messes, odors and pet homelessness disappear.

Visit **[BISSELLsavespets.com](https://www.bissellsavespets.com)** to learn more.



## Love your BISSELL® product?

Don't keep it a secret. Let us, and millions of others, know what you think! Leave your star-rating on **[BISSELL.com](https://www.bissell.com)**.



©2021 BISSELL Inc. All rights reserved.  
Part Number 1622075 09/21